

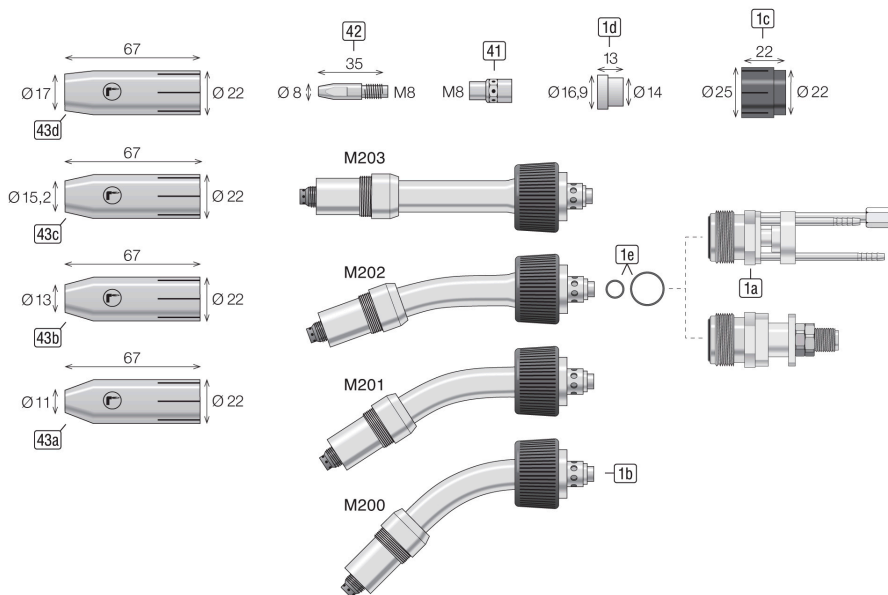

# Data Sheet

## MultiMig RM400W



00.DBL-M.F001.M2

04-2018

### Components

#	Item description	Part no
1a	Torch body MultiMig air cooled	M.F001.ML00
	Torch body MultiMig water cooled	M.F001.MW00
1e	O-Ring torch body MultiMig 8x2	M.F001.MW00-01
	O-Ring torch body MultiMig 16x2	M.F001.MW00-02
1b	Torch Neck MultiMig RM300L/400W Bending 45° Length 148,0mm	M.F001.M200
	Torch Neck MultiMig RM300L/400W Bending 30° Length 163,5mm	M.F001.M201
	Torch Neck MultiMig RM300L/400W Bending 15° Length 171,5mm	M.F001.M202
	Torch Neck MultiMig RM300L/400W Bending 0° Length 172,5mm	M.F001.M203

### Wearing parts

#	Item description	Part no
1c	Fixing Sleeve iØ22mm aØ25mm L=22mm RM300L/400W	M.F002.0211
1d	Insulator iØ14mm aØ16,9mm L=13mm RM300L	M.F002.0111
41	Tip Holder M8 SW14 L=28mm RM300L/400W	M.F002.0311
42	Contact Tip CuCrZr M8 L=35mm Ø0,8mm RM300L/400W	M.F004.0201
	Contact Tip CuCrZr M8 L=35mm Ø0,9mm RM300L/400W	M.F004.0202
	Contact Tip CuCrZr M8 L=35mm Ø1,0mm RM300L/400W	M.F004.0203
	Contact Tip CuCrZr M8 L=35mm Ø1,2mm RM300L/400W	M.F004.0204
	Contact Tip CuCrZr M8 L=35mm Ø0,8mm ZB4,1 RM300L/400W - Alu-Wire	M.F004.0221
	Contact Tip CuCrZr M8 L=35mm Ø1,0mm ZB4,1 RM300L/400W - Alu-Wire	M.F004.0222
	Contact Tip CuCrZr M8 L=35mm Ø1,2mm ZB4,1 RM300L/400W - Alu-Wire	M.F004.0223
	Contact Tip CuCrZr M8 L=35mm Ø1,4mm ZB4,1 RM300L/400W - Alu-Wire	M.F004.0224
43a	Nozzle iØ11,0 L=67mm strong conical RM300L/400W	M.F003.0113
43b	Nozzle iØ13,0 L=67mm conical RM300L/400W	M.F003.0112
43c	Nozzle iØ15,2 L=67mm conical RM300L/400W	M.F003.0111
43d	Nozzle iØ17,0 L=67mm cylindrical RM300L/400W	M.F003.0110