



# Hoja de datos

## Boquilla TIG Cuarzo

**WeldTec**

### WT-9, -20, -25

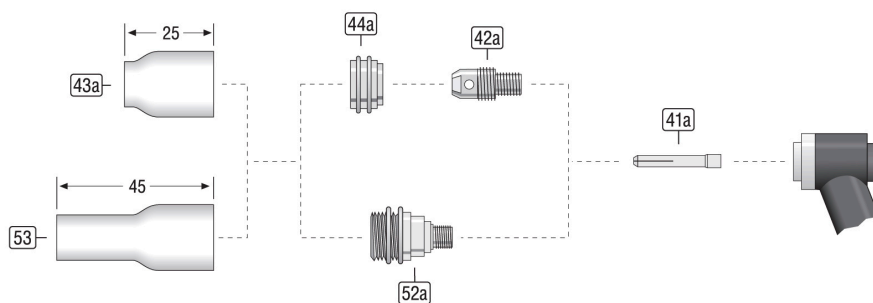

### WT-17, -18, -26

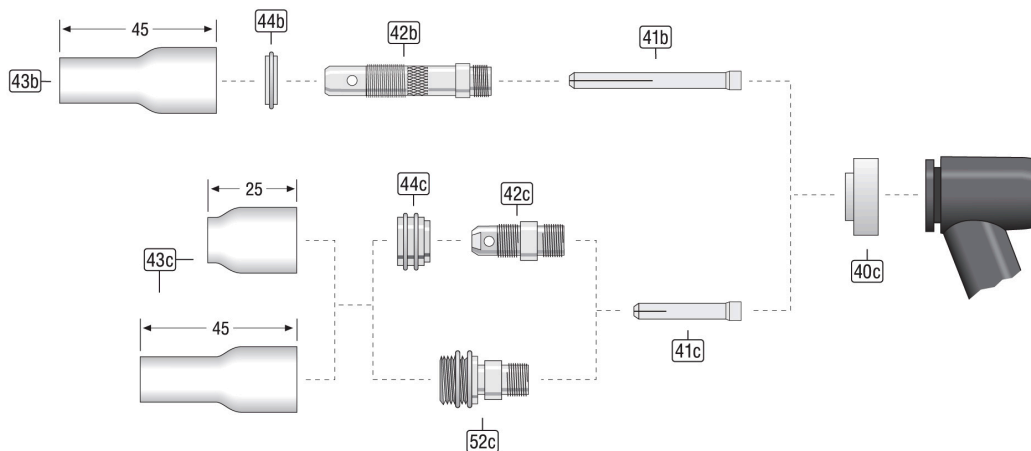

### WT-24

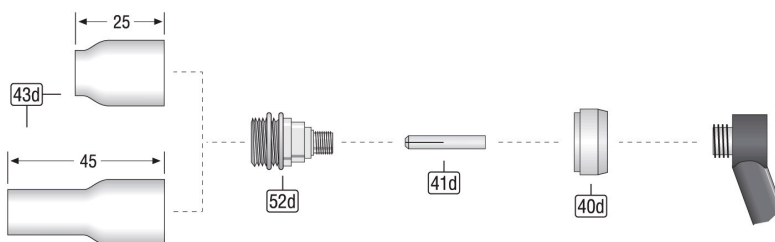

**Consumibles WT9,20,25, I-Head, SW320, 320SA**

Pos.	Denominación de artículo	Artículo
	Caja Boquilla TIG Cuarzo Ø1,6/2,4/3,2mm WT-9/20 SW-320	859-QN-20B
	Set Ø1,6mm Difusor de Gas WT-9/20/25 SW-320	859-QN-20-16
	Set Ø2,4mm Difusor de Gas WT-9/20/25 SW-320	859-QN-20-24
	Set Ø3,2mm Difusor de Gas WT-9/20/25 SW-320	859-QN-20-32
	Set Ø1,6mm Gas-Lens WT-9/20/25 SW-320	859-QN-20-16G
	Set Ø2,4mm Gas-Lens WT-9/20/25 SW-320	859-QN-20-24G
	Set Ø3,2mm Gas-Lens WT-9/20/25 SW-320	859-QN-20-32G
	Set Ø1,6mm Gas-Lens Tobera L WT-9/20/25 SW-320	859-QN-20-16GL
	Set Ø2,4mm Gas-Lens Tobera L WT-9/20/25 SW-320	859-QN-20-24GL
	Set Ø3,2mm Gas-Lens Tobera L WT-9/20/25 SW-320	859-QN-20-32GL
41a	Porta-Electrodo Ø1,0mm L=25mm [13N21] WT-9/20/25 SW-320 WT-22/23	85113210-W
	Porta-Electrodo Ø1,6mm L=25mm [13N22] WT-9/20/25 SW-320 WT-22/23	85113220-W
	Porta-Electrodo Ø2,4mm L=25mm [13N23] WT-9/20/25 SW-320 WT-22/23	85113230-W
	Porta-Electrodo Ø3,2mm L=25mm [13N24] WT-9/20/25 SW-320 WT-22/23	85113240-W
42a	Difusor de Gas Ø1,0mm [13N26] WT-9/20/25 SW-320 WT-22/23	85123260-W
	Difusor de Gas Ø1,6mm [13N27] WT-9/20/25 SW-320 WT-22/23	85123270-W
	Difusor de Gas Ø2,4mm [13N28] WT-9/20/25 SW-320 WT-22/23	85123280-W
	Difusor de Gas Ø3,2mm [13N29] WT-9/20/25 SW-320 WT-22/23	85123290-W
44a	Adaptador Anillo Difusor de Gas [13NQA] WT-9/20/25 SW-320	859-QN20A
43a	Tobera Cristal #5 [13NQ-5] WT-9/20/24/25 SW-320	859-QN050
	Tobera Cristal #7 [13NQ-7] WT-9/20/24/25 SW-320	859-QN070
	Tobera Cristal #9 [13NQ-9] WT-9/20/24/25 SW-320	859-QN090
52a	Gas-Lens Ø1,6mm [45V43NQ] WT-9/20/24/25 SW-320	859-QN20-16G
	Gas-Lens Ø2,4mm [45V44NQ] WT-9/20/24/25 SW-320	859-QN20-24G
	Gas-Lens Ø3,2mm [45V45NQ] WT-9/20/24/25 SW-320	859-QN20-32G
53	Tobera Cristal #5L [13NQ-5L] WT-9/20/24/25 SW-320	859-QN05L
	Tobera Cristal #7L [10NQ-7L] WT-17/18/26	859-QN07L
	Tobera Cristal #9L [10NQ-9L] WT-17/18/26	859-QN09L

**Consumibles WT17,18,26 I-Head**

Pos.	Denominación de artículo	Artículo
	Caja Boquilla TIG Cuarzo Ø1,6/2,4/3,2mm WT-17/18/26 SW-418	859-QN-17B
	Set Ø1,6mm Difusor de Gas WT-17/18/26 SW-418	859-QN-17-16
	Set Ø2,4mm Difusor de Gas WT-17/18/26 SW-418	859-QN-17-24
	Set Ø3,2mm Difusor de Gas WT-17/18/26 SW-418	859-QN-17-32
	Set Ø1,6mm Gas-Lens Stubby WT-17/18/26 SW-418	859-QN-17-16GS
	Set Ø2,4mm Gas-Lens Stubby WT-17/18/26 SW-418	859-QN-17-24GS
	Set Ø3,2mm Gas-Lens Stubby WT-17/18/26 SW-418	859-QN-17-32GS
	Set Ø1,6mm Difusor de Gas Stubby WT-17/18/26 SW-418	859-QN-17-16S
	Set Ø2,6mm Difusor de Gas Stubby WT-17/18/26 SW-418	859-QN-17-24S
	Set Ø3,2mm Difusor de Gas Stubby WT-17/18/26 SW-418	859-QN-17-32S
40c	Aislador [10NQG] WT-17/18/26	859-QN17I
41b	Porta-Electrodo Ø1,0mm L=50mm [10N22] WT-17/18/26 WT-28/29	85110220-W
	Porta-Electrodo Ø1,6mm L=50mm [10N23] WT-17/18/26 WT-28/29	85110230-W
	Porta-Electrodo Ø2,4mm L=50mm [10N24] WT-17/18/26 WT-28/29	85110240-W
	Porta-Electrodo Ø3,2mm L=50mm [10N25] WT-17/18/26 WT-28/29	85110250-W
42b	Difusor de Gas Ø1,0mm [10N30] WT-17/18/26 WT-28/29	85120300-W
	Difusor de Gas Ø1,6mm [10N31] WT-17/18/26 WT-28/29	85120310-W
	Difusor de Gas Ø2,4mm [10N32] WT-17/18/26 WT-28/29	85120320-W
	Difusor de Gas Ø3,2mm [10N28] WT-17/18/26 WT-28/29	85120280-W
44b	Adaptador Anillo Difusor de Gas [10NQA] WT-17/18/26	859-QN17A
43b	Tobera Cristal #7L [10NQ-7L] WT-17/18/26	859-QN07L
	Tobera Cristal #9L [10NQ-9L] WT-17/18/26	859-QN09L
41c	Porta-Electrodo Ø1,6mm L=29,5mm [10N23S] WT-17/18/26 WT-28/29	85110231-W
	Porta-Electrodo Ø2,4mm L=29,5mm [10N24S] WT-17/18/26 WT-28/29	85110241-W
	Porta-Electrodo Ø3,2mm L=29,5mm [10N25S] WT-17/18/26 WT-28/29	85110251-W
42c	Carcasa Ø1,0-3,2mm [17CB20] WT-17/18/26 WT-28/29	85122000-W
44c	Adaptador Anillo Difusor de Gas [13NQA] WT-9/20/25 SW-320	859-QN20A
52c	Gas-Lens Ø1,6mm [17GL116] WT-17/18/26	85131716-W
	Gas-Lens Ø2,4mm [17GL332] WT-17/18/26	85131724-W
	Gas-Lens Ø3,2mm [17GL18] WT-17/18/26	85131732-W
43c	Tobera Cristal #5 [13NQ-5] WT-9/20/24/25 SW-320	859-QN050

**Prohibidos la reproducción y difusión en cualquier forma,**

© Rohrman Schweißtechnik GmbH - Viersen - Germany - www.rohrman.de - info@rohrman.de

Tobera Cristal #7 [13NQ-7] WT-9/20/24/25 SW-320	859-QN070
Tobera Cristal #9 [13NQ-9] WT-9/20/24/25 SW-320	859-QN090
Tobera Cristal #5L [13NQ-5L] WT-9/20/24/25 SW-320	859-QN05L
Tobera Cristal #7L [10NQ-7L] WT-17/18/26	859-QN07L
Tobera Cristal #9L [10NQ-9L] WT-17/18/26	859-QN09L

### Consumibles WT24

Pos.	Denominación de artículo	Artículo
	Set Ø1,6mm Gas-Lens WT-24/24W	859-QN-24-16G
	Set Ø2,4mm Gas-Lens WT-24/24W	859-QN-24-24G
	Set Ø1,6mm Gas-Lens Tobera L WT-24/24W	859-QN-24-16GL
	Set Ø2,4mm Gas-Lens Tobera L WT-24/24W	859-QN-24-24GL
40d	Aislador Gas-Lens [53N66] WT-24/24W	85504660-W
41d	Porta-Electrodo Ø1,6mm L=23mm [53N64] WT-24/24W	85113640-W
	Porta-Electrodo Ø2,4mm L=23mm [24GLC332] WT-24/24W	85113323-W
52d	Gas-Lens Ø1,6mm [45V43NQ] WT-9/20/24/25 SW-320	859-QN20-16G
	Gas-Lens Ø2,4mm [45V44NQ] WT-9/20/24/25 SW-320	859-QN20-24G
43d	Tobera Cristal #5 [13NQ-5] WT-9/20/24/25 SW-320	859-QN050
	Tobera Cristal #7 [13NQ-7] WT-9/20/24/25 SW-320	859-QN070
	Tobera Cristal #9 [13NQ-9] WT-9/20/24/25 SW-320	859-QN090
	Tobera Cristal #5L [13NQ-5L] WT-9/20/24/25 SW-320	859-QN05L
	Tobera Cristal #7L [10NQ-7L] WT-17/18/26	859-QN07L
	Tobera Cristal #9L [10NQ-9L] WT-17/18/26	859-QN09L