

# WeldTec®

## MEGAFLO™

### TIG Torch Glass Nozzle



WT-20 Shown

From the company who introduced clear glass TIG nozzles to the welding industry ... comes the MegaFlo™ nozzle.

- Better weld visibility
- Maximum weld zone gas protection
- Replaceable screens and electrode guides

The MegaFlo™ nozzle provides complete weld zone protection for critical welding of reactive metals such as titanium, molybdenum, nickel alloys, stainless alloys and others. Useable on most hand held and machine TIG torches.

TORCH SERIES	DESCRIPTION	SIZE	PART NO.
<b>WT-17, 18, 26</b> <b>WT-28, 29</b> <b>i-Heads</b>	MegaFlo™ Nozzle	1/16 (1,6)	MF10-16
	Includes: glass nozzle, teflon gasket, collet, megaflo body assembly with screen pack, o-ring, electrode guide.	3/32 (2,4)	MF10-32
		1/8 (3,2)	MF10-18
	MegaFlo™ Nozzle Kit	All 3 Sizes	MF10NK
	Includes: glass nozzle, teflon gasket, megaflo body assembly with screen pack, o-ring, all 3 electrode guides and collets 1/16, 3/32, 1/8.	1/16	
		3/32	
		1/8	

TORCH SERIES	DESCRIPTION	SIZE	PART NO.
<b>WT-9, 20, 25</b> <b>WT-22, 23</b> <b>SW-320</b> <b>i-Heads</b>	MegaFlo™ Nozzle	1/16 (1,6)	MF13-16
	Includes: glass nozzle, teflon gasket, collet, megaflo body assembly with screen pack, o-ring, electrode guide.	3/32 (2,4)	MF13-32
		1/8 (3,2)	MF13-18
	MegaFlo™ Nozzle Kit	All 3 Sizes	MF13NK
	Includes: glass nozzle, teflon gasket, megaflo body assembly with screen pack, o-ring, all 3 electrode guides and collets 1/16, 3/32, 1/8.	1/16	
		3/32	
		1/8	



30 cfm Gas Flow



WeldTec® – “where quality and innovation never ends”

Made in USA

Specifications subject to change without notice.



# WeldTec®

## MEGAFLO™ Glass Nozzles

**WT-17, 18, 26  
WT-28, 29  
I-HEAD  
TORCH SERIES**

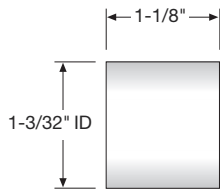

**GLASS NOZZLE**  
MF1013N

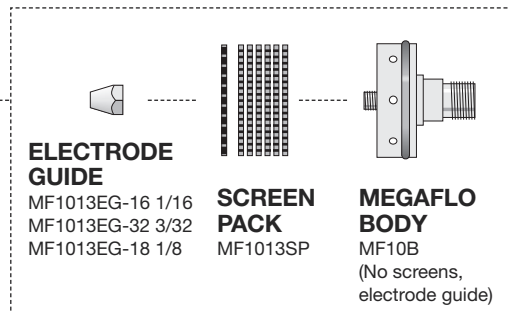

**ELECTRODE GUIDE**

MF1013EG-16 1/16  
MF1013EG-32 3/32  
MF1013EG-18 1/8

**SCREEN PACK**  
MF1013SP

**MEGAFLO BODY**  
MF10B  
(No screens, electrode guide)

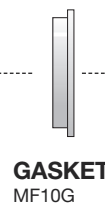

**GASKET**  
MF10G



**STUBBY COLLET**  
10N23S 1/16  
10N24S 3/32  
10N25S 1/8

**TORCH BODY**

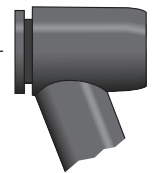

**WT-9, 20, 25  
WT-22, 23, SW-320  
I-HEAD  
TORCH SERIES**

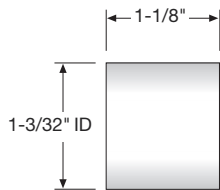

**GLASS NOZZLE**  
MF1013N

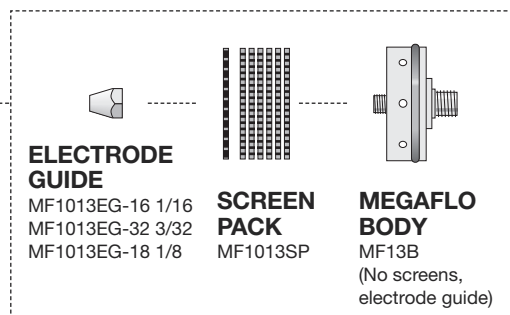

**ELECTRODE GUIDE**

MF1013EG-16 1/16  
MF1013EG-32 3/32  
MF1013EG-18 1/8

**SCREEN PACK**  
MF1013SP

**MEGAFLO BODY**  
MF13B  
(No screens, electrode guide)

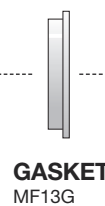

**GASKET**  
MF13G



**COLLET**  
13N22 1/16  
13N23 3/32  
13N24 1/8

**TORCH BODY**



**REPLACEMENT SCREEN PACK  
MF1013SP**



**1 BAFFLE**



**6 SCREENS**

Specifications subject to change without notice.