

ROHRMAN
SCHWEISSTECHNIK

CATALOGUE 1.Q&1.P

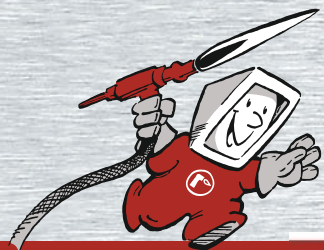

07/2012

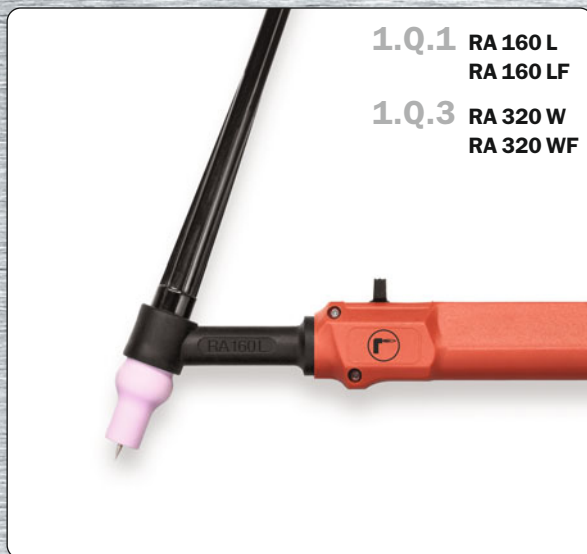

Rohrman Schweißtechnik GmbH
Kränkelsweg 34a - 41748 Viersen

Tel.: +49(0)2162 / 10 60 65-0
Fax: +49(0)2162 / 10 60 65-55

www.rohrman.de
info@rohrman.de

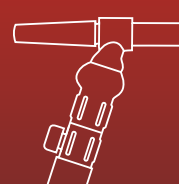
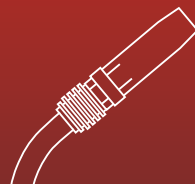
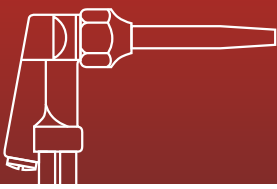

Rohrman Schweißtechnik Torches and more ... Partner for welding distributors

Rohrman Schweißtechnik – a family company with more than 40 years of experience in welding technology.

We offer a variety of products for welding such as:

- TIG torches in different styles
- TIG spare parts and accessories
- TIG extension packages
- MIG/MAG torches in different styles
- MIG/MAG spare parts and accessories
- MIG/MAG extension- and interconnection cable packages
- Electrodes-, earth clamps- and cables
- Welding helmets
- Flame cutting torches, hoses and accessories
- Carbon arc gouging torches and accessories

In addition to standard torches we are specialized in **Tungsten Inert Gas** Welding. The wide range of products enables us to provide optimal solutions for different welding applications.

Please ask your welding distributor or feel free to contact us.

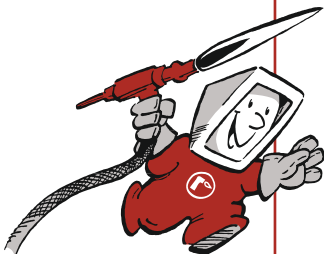

Rohrman Schweißtechnik

Tel.: +49(0)2162/106065-0

Fax: +49(0)2162/106065-55

www.rohrman.de · info@rohrman.de



TIG-Torch-Series A&P



TIG Torches A & P-Series

The TIG-Torch-Series A&P is available in the **air cooled version** up to **220 amps** and in the **water cooled version** up to **400 amps**.

A-Series

- **push-on gas nozzles**
- **torch bodies in two sizes**
in each case air and water cooled
- **compact, ergonomic handle**

The A-series has **push-on gas nozzles** that were mounted on the conical brass shaft of the torch body.

Because of the special bulb form of the gas nozzle the gas will be lead through the nozzle almost without turbulences.



Model	Capacity		Duty Cycle	Electrode Ø
	Highflex Torch Package	DVOH Torch Package		
RA 160 L	110 A-DC · 95 A-AC	160 A-DC · 120 A-AC	40 %	1.0-2.4 mm
RA 220 L	180 A-DC · 130 A-AC	220 A-DC · 180 A-AC	40 %	1.0-3.2 mm
RA 320 W	250 A-DC · 200 A-AC	300 A-DC · 250 A-AC	60 %	1.0-3.2 mm
RA 420 W	350 A-DC · 300 A-AC	400 A-DC · 360 A-AC	60 %	1.0-4.0 mm

Technical specifications conform to EN 60 974-7



P-Series

- **screwable gas nozzles**
- **spare parts** mostly compatible with the international standard
- **torch bodies** in two sizes in each case air and water cooled
- **compact, ergonomic handle**

The P-series has **screwable gas nozzles** that are compatible with the international standard. The most spare parts are compatible with the spare parts of the SR-series.

It is also possible to get a torch package A&P-series in a flexible version so that the welder can bend the torch body into the needed direction.

The description of the torch will be completed with **"F"** for flexible.

Model	Capacity		Duty Cycle	Electrode Ø
	Highflex Torch Package	DVOH Torch Package		
RP 160 L	125 A-DC · 80 A-AC	160 A-DC · 120 A-AC	40 %	1.0-2.4 mm
RP 220 L	180 A-DC · 130 A-AC	220 A-DC · 180 A-AC	40 %	1.0-3.2 mm
RP 320 W	250 A-DC · 200 A-AC	300 A-DC · 250 A-AC	60 %	1.0-3.2 mm
RP 420 W	350 A-DC · 300 A-AC	400 A-DC · 360 A-AC	60 %	1.0-4.0 mm

Technical specifications conform to EN 60 974-7



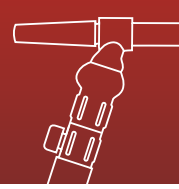
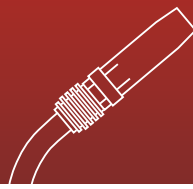
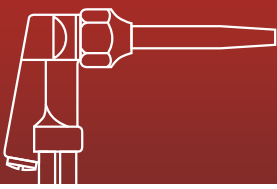

TIG Spare Parts

Spare Parts A-Series



Spare Parts P-Series



Connection for basic torch packages

for RA 160 L/RA 160 LF/RA 220 L/RA 220 LF/
RP 160 L/RP 160 LF/RP 220 L/RP 220 LF:

Basic torch package with connection EC

Power gas cable ... M10x1 right hand male
thread with bend protection

Control cable ... open, 30 cm longer than
power gas cable



for RA 320 W/RA 320 WF/RA 420 W/RA 420 WF/
RP 320 W/RP 320 WF/RP 420 W/RP 420 WF:

Basic torch package with connection EC

Power water cable ... M10x1 right hand male
thread with bend protection

Hose water forward ... open, 30 cm longer
than power water cable

Gas hose ... open, 30 cm longer than power
water cable

Control cable ... open, 30 cm longer than
power water cable



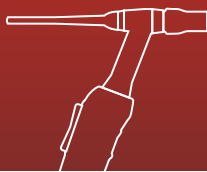

ROHRMAN
SCHWEISSTECHNIK

1.Q.1

A-Series RA160L



TIG Torch Package RA 160 L/RA 160 LF

Capacity at 40 % duty cycle (10 min. cycle):

Highflex torch package: 110 amps – DC – direct current
95 amps – AC – alternating current

DVOH torch package (reinforced): 160 amps – DC – direct current
120 amps – AC – alternating current

Type of cooling: Air cooling

Wire diameter: 1.0–2.4 mm

Standard: Conform to EN 60974-7

Connection: Suitable for any power supply in the market

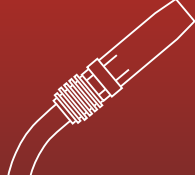
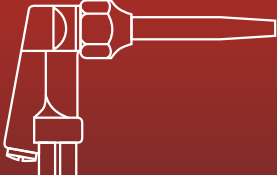

RA 160 L, air cooled

Highflex torch package

110 A – DC – 40 % duty cycle

95 A – AC – 40 % duty cycle

DVOH torch package (reinforced)

160 A – DC – 40 % duty cycle

120 A – AC – 40 % duty cycle

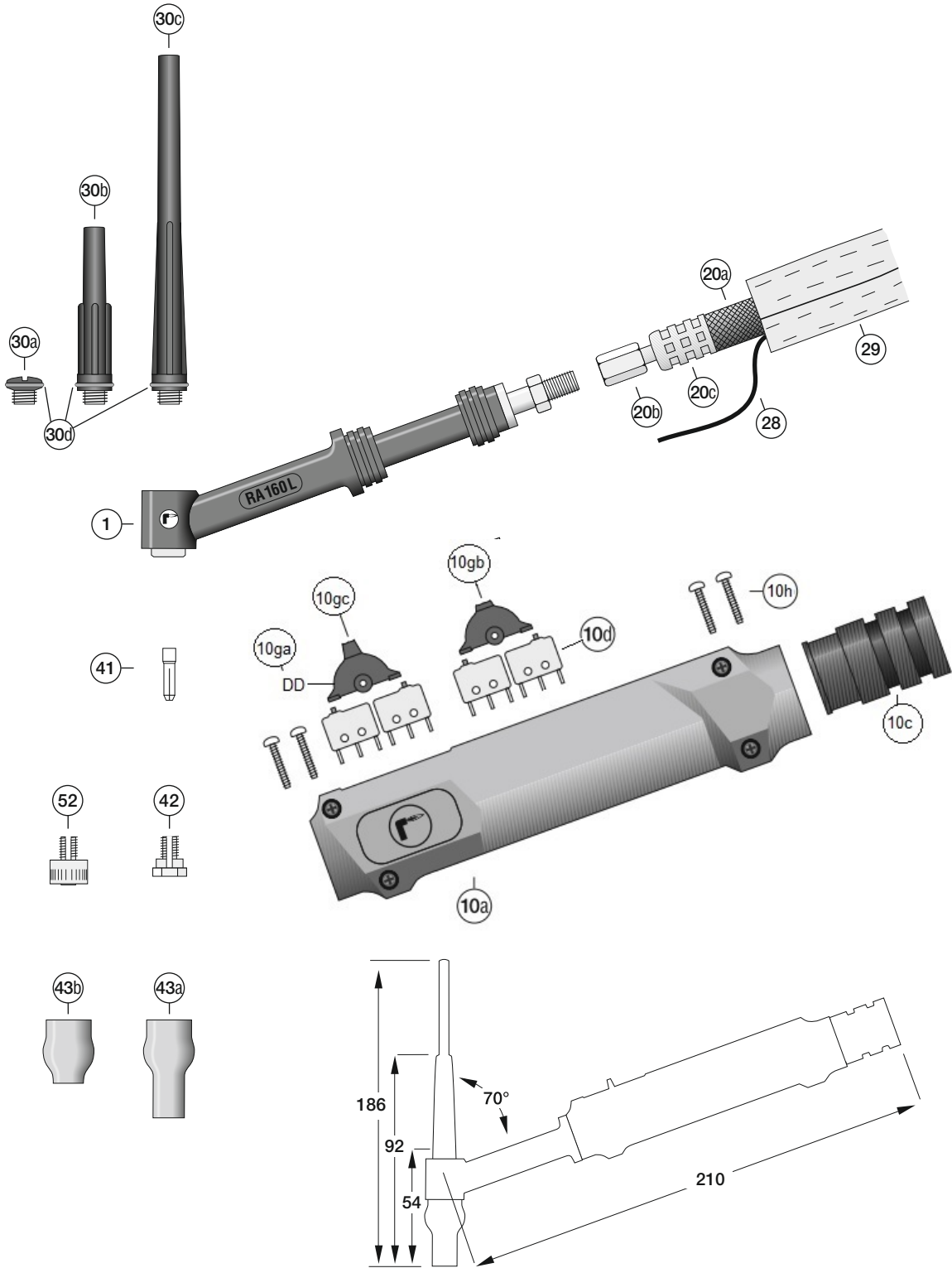



TIG Torch RA 160 L/RA 160 LF

TIG Torches Highflex With Basic Torch Package

Position	Article Description	Order Number
	RA 160 L/4 m, Leather+Rubber, Handle-Double Switch – Connection EC	84B1Q16004EC17D
	RA 160 L/8 m, Leather+Rubber, Handle-Double Switch – Connection EC	84B1Q16008EC17D
	RA 160 L/4 m, Leather+Rubber, Handle-Double Switch-UpDown – Connection EC	84B1Q16004EC17U
	RA 160 L/8 m, Leather+Rubber, Handle-Double Switch-UpDown – Connection EC	84B1Q16008EC17U

TIG Torch DVOH With Basic Torch Package

Position	Article Description	Order Number
	RA 160 L/4 m, Leather+Rubber, Handle-Double Switch – Connection EC	84BVQ16004EC17D
	RA 160 L/8 m, Leather+Rubber, Handle-Double Switch – Connection EC	84BVQ16008EC17D
	RA 160 L/4 m, Leather+Rubber, Handle-Double Switch-UpDown – Connection EC	84BVQ16004EC17U
	RA 160 L/8 m, Leather+Rubber, Handle-Double Switch-UpDown – Connection EC	84BVQ16008EC17U

Replacement Parts Torch Body

Position	Article Description	Order Number
1a	Torch Body RA 160 L	8560Q160
	Torch Body RA 160 LF Flexible	8560Q162

Replacement Parts Handle

Position	Article Description	Order Number
	Handle SET Double Switch	8550317DD
	Handle SET Double Switch-UpDown	8550317UP
10a	Handle Pair (le+ri) Red	8550317Z1-1RT2
10c	Handle Bracket	8550304Z2-12
10d	Handle Micro Switch	8550317Z5-11
10ga	Handle Double Button	8550317Z4-21
10gb	Handle Switch UpDown Small	8550317Z4-312
10gc	Handle Switch UpDown Large	8550317Z4-311
10h	Handle Screw	8550317Z1-9

Replacement Parts Torch Package Highflex

Position	Article Description	Order Number
	Package/4 m, Leather+Rubber, G-Cu-W, RA 160 L	83B1P16004M10x1G#-U
	Package/8 m, Leather+Rubber, G-Cu-W, RA 160 L	83B1P16008M10x1G#-U
	Power Cable/4 m, Rubber, Strand-Cu, RA 160 L	821P16004M10x1G#
	Power Cable/8 m, Rubber, Strand-Cu, RA 160 L	821P16008M10x1G#
20a	Hose Overbraided Rubber 8x12 Black/Red	855130812SR
20b	Power Connector M8x1 RH Swivel Nut-L- 8 mm	85505521108R-L
20c	Ferrule A500L – Alu	85519A126
28	Control Cable 7x0.25FD	855180107025FD
29	Cable Cover Sheath Rubber Ø 23 mm	8551402310
	Leather Adapter Ø 22–28 mm (3-pcs)	8551002001
	Cable Cover Sheath /1 m Leather Ø 22 mm Black	85514Z0222

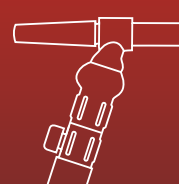
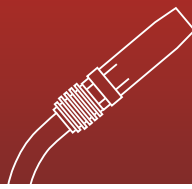
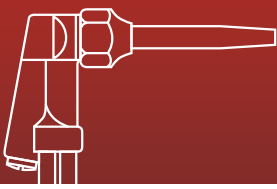

Spare Parts

Position	Article Description	Order Number
30b	Back Cap Medium L=55 mm	85742930
30c	Back Cap Long L=152 mm	85742970
41	Collet Ø 1.0 mm L=12.7 mm	85114441
	Collet Ø 1.6 mm L=12.7 mm	85114451
	Collet Ø 2.4 mm L=12.7 mm	85114461
	Collet Ø 3.2 mm L=12.7 mm	85114471
42	Chuck Ø 1.0 mm L=10.3 mm	85129614
	Chuck Ø 1.6 mm L=10.3 mm	85129615
	Chuck Ø 2.4 mm L=10.3 mm	85129616
	Chuck Ø 3.2 mm L=10.3 mm	85129617
52	Gas Lens Ø 1.6 mm L=12.5 mm	85131416
	Gas Lens Ø 2.4 mm L=12.5 mm	85131424
	Gas Lens Ø 3.2 mm L=12.5 mm	85131432
43a	Gas Nozzle Size 4 iØ 6.4 mm L=33 mm	85230115
	Gas Nozzle Size 5 iØ 8.0 mm L=33 mm	85231115
	Gas Nozzle Size 6 iØ 9.6 mm L=33 mm	85232115
	Gas Nozzle Size 7 iØ 11.2 mm L=33 mm	85233115
43b	Gas Nozzle Size 4 iØ 6.4 mm L=22 mm	85230015
	Gas Nozzle Size 5 iØ 8.0 mm L=22 mm	85231015
	Gas Nozzle Size 6 iØ 9.6 mm L=22 mm	85232015
30a	Back Cap Short L=12 mm	85742913



ROHRMAN
SCHWEISSTECHNIK

1.Q.2

A-Series RA 220 L



TIG Torch Package RA 220 L/RA 220 LF

Capacity at 40 % duty cycle (10 min. cycle):

Highflex torch package: 180 amps – DC – direct current
130 amps – AC – alternating current

DVOH torch package (reinforced): 220 amps – DC – direct current
180 amps – AC – alternating current

Type of cooling: Air cooling

Wire diameter: 1.0–3.2 mm

Standard: Conform to EN 60 974-7

Connection: Suitable for any power supply in the market

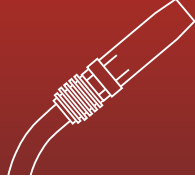
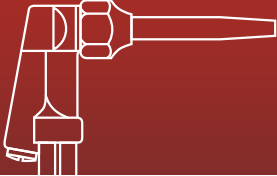

RA 220 L, air cooled

Highflex torch package

180 A – DC – 40 % duty cycle

130 A – AC – 40 % duty cycle

DVOH torch package (reinforced)

220 A – DC – 40 % duty cycle

180 A – AC – 40 % duty cycle

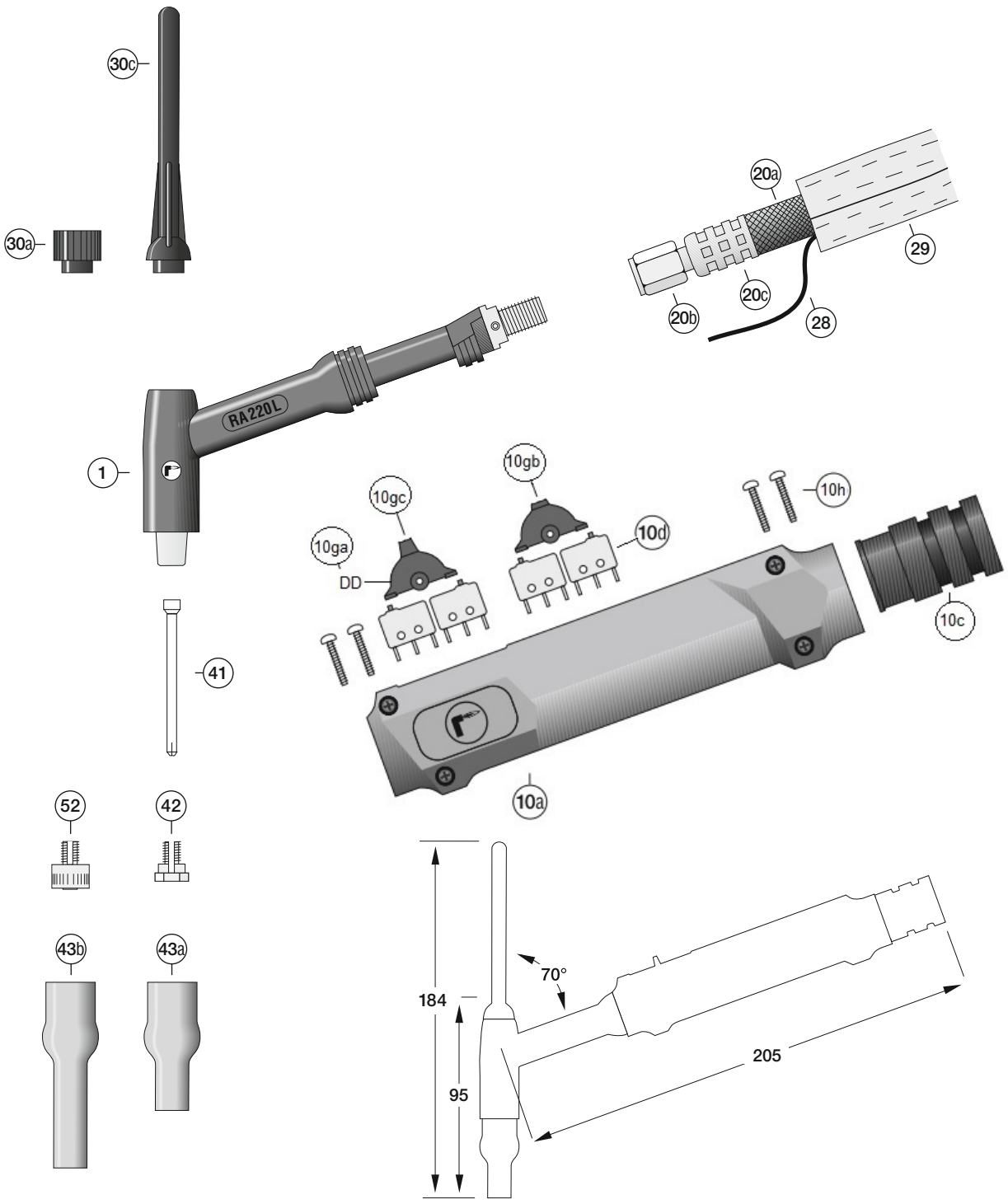



TIG Torch RA 220 L/RA 220 LF

TIG Torches Highflex With Basic Torch Package

Position	Article Description	Order Number
	RA 220 L/4 m, Leather+Rubber, Handle-Double Switch – Connection EC	84B1Q22004EC17D
	RA 220 L/8 m, Leather+Rubber, Handle-Double Switch – Connection EC	84B1Q22008EC17D
	RA 220 L/4 m, Leather+Rubber, Handle-Double Switch-UpDown – Connection EC	84B1Q22004EC17U
	RA 220 L/8 m, Leather+Rubber, Handle-Double Switch-UpDown – Connection EC	84B1Q22008EC17U

TIG Torch DVOH With Basic Torch Package

Position	Article Description	Order Number
	RA 220 L/4 m, Leather+Rubber, Handle-Double Switch – Connection EC	84BVQ22004EC17D
	RA 220 L/8 m, Leather+Rubber, Handle-Double Switch – Connection EC	84BVQ22008EC17D
	RA 220 L/4 m, Leather+Rubber, Handle-Double Switch-UpDown – Connection EC	84BVQ22004EC17U
	RA 220 L/8 m, Leather+Rubber, Handle-Double Switch-UpDown – Connection EC	84BVQ22008EC17U

Replacement Parts Torch Body

Position	Article Description	Order Number
1a	Torch Body RA 220 L	8560Q220
	Torch Body RA 220 LF flexible	8560Q222

Replacement Parts Handle

Position	Article Description	Order Number
	Handle SET Double Switch	8550317DD
	Handle SET Double Switch-UpDown	8550317UP
10a	Handle Pair (le+ri) Red	8550317Z1-1RT2
10c	Handle Bracket	8550304Z2-12
10d	Handle Micro Switch	8550317Z5-11
10ga	Handle Double Button	8550317Z4-21
10gb	Handle Switch UpDown Small	8550317Z4-312
10gc	Handle Switch UpDown Large	8550317Z4-311
10h	Handle Screw	8550317Z1-9

Replacement Parts Torch Package Highflex

Position	Article Description	Order Number
	Package/4 m, Leather+Rubber, G-Cu-W, RA 220 L	83B1P22004M10x1G#-U
	Package/8 m, Leather+Rubber, G-Cu-W, RA 220 L	83B1P22008M10x1G#-U
	Power Cable/4 m, Rubber-Cu-W, RA 220 L	821P22004M10x1G#
	Power Cable/8 m, Rubber-Cu-W, RA 220 L	821P22008M10x1G#
20a	Hose Overbraided Rubber 10x14 Black/Red	855131014SR
20b	Power Connector M10x1 RH Swivel Nut-L- 10 mm	85505522110R-L
20c	Ferrule A575L – Alu	85519A146
20d	Power Connector M10x1 RH Male Thread – 10 mm	85505522310R
28	Control Cable LiYY-FD 7x0.25	855180107025FD
29	Cable Cover Sheath Rubber Ø 23 mm	8551402310
	Leather Adapter Ø 22–28 mm (3-pcs)	8551002001
	Cable Cover Sheath/1 m Leather Ø 22 mm Black	85514Z0222

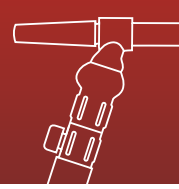
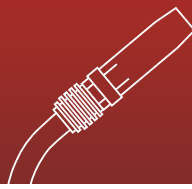
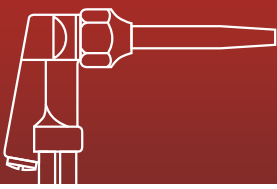

Spare Parts

Position	Article Description	Order Number
30a	Back Cap Short L=15 mm	85711132
30c	Back Cap Long L=103 mm	85711172
41	Collet Ø 1.0 mm L=59 mm	85119640
	Collet Ø 1.6 mm L=59 mm	85119650
	Collet Ø 2.4 mm L=59 mm	85119660
	Collet Ø 3.2 mm L=59 mm	85119670
	Collet Ø 4.0 mm L=59 mm	85119680
42	Chuck Ø 1.0 mm L=10.3 mm	85129614
	Chuck Ø 1.6 mm L=10.3 mm	85129615
	Chuck Ø 2.4 mm L=10.3 mm	85129616
	Chuck Ø 3.2 mm L=10.3 mm	85129617
	Chuck Ø 4.0 mm L=10.3 mm	85129618
52	Gas Lens Ø 1.6 mm L=12.5 mm	85131416
	Gas Lens Ø 2.4 mm L=12.5 mm	85131424
	Gas Lens Ø 3.2 mm L=12.5 mm	85131432
43a	Gas Nozzle Size 4 iØ 6.4 mm L=44 mm	85230005
	Gas Nozzle Size 5 iØ 8.0 mm L=44 mm	85231005
	Gas Nozzle Size 6 iØ 9.6 mm L=44 mm	85232005
	Gas Nozzle Size 7 iØ 11.2 mm L=44 mm	85233005
	Gas Nozzle Size 8 iØ 12.8 mm L=44 mm	85234005
	Gas Nozzle Size 9 iØ 14.4 mm L=44 mm	85235005
	Gas Nozzle Size 10 iØ 16.0 mm L=44 mm	85236005
43b	Gas Nozzle Size 4 iØ 6.4 mm L=64 mm	85230075
	Gas Nozzle Size 5 iØ 8.0 mm L=64 mm	85231075
	Gas Nozzle Size 6 iØ 9.6 mm L=64 mm	85232075
	Gas Nozzle Size 7 iØ 11.2 mm L=64 mm	85233075

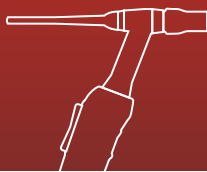

1.Q.3

A-Series RA 320 W



TIG Torch Package RA 320 W/RA 320 WF

Capacity at 60 % duty cycle (10 min. cycle):

Highflex torch package: 250 amps – DC – direct current
200 amps – AC – alternating current

DVOH torch package (reinforced): 300 amps – DC – direct current
250 amps – AC – alternating current

Type of cooling: Water cooling

Wire diameter: 1.0–3.2 mm

Standard: Conform to EN 60 974-7

Connection: Suitable for any power supply in the market

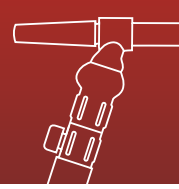
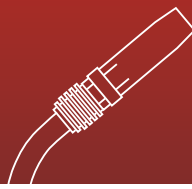
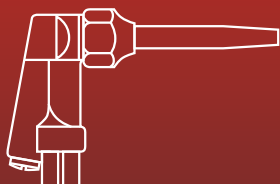

RA 320 W, water cooled

Highflex torch package

250 A – DC – 60% duty cycle

200 A – AC – 60% duty cycle

DVOH torch package (reinforced)

300 A – DC – 60% duty cycle

250 A – AC – 60% duty cycle

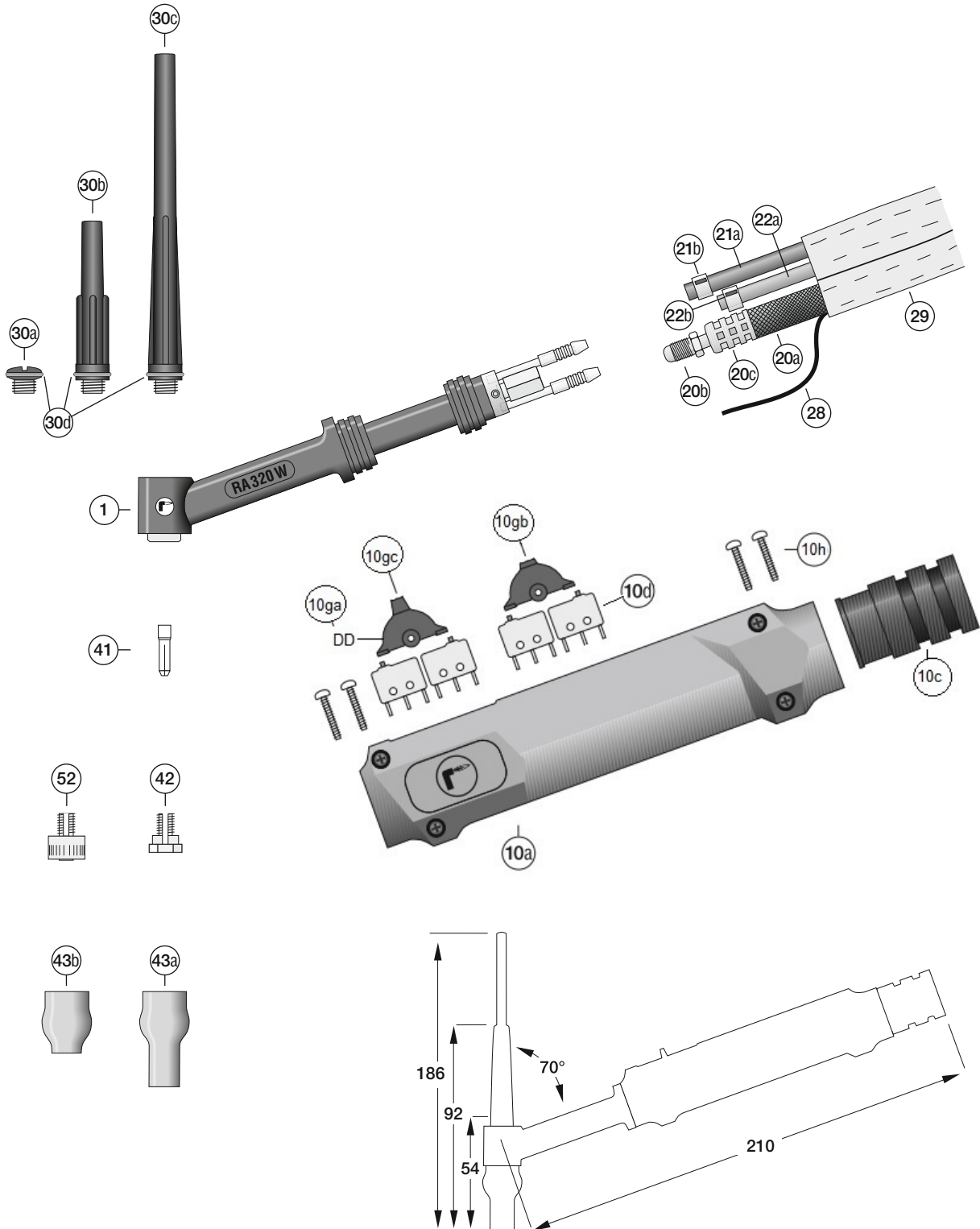



TIG Torch RA 320 W/RA 320 WF

TIG Torches Highflex With Basic Torch Package

Position	Article Description	Order Number
	RA 320 W/4 m, Leather+Rubber, Handle-Double Switch – Connection EC	84B1Q32004EC17D
	RA 320 W/8 m, Leather+Rubber, Handle-Double Switch – Connection EC	84B1Q32008EC17D
	RA 320 W/4 m, Leather+Rubber, Handle-Double Switch-UpDown – Connection EC	84B1Q32004EC17U
	RA 320 W/8 m, Leather+Rubber, Handle-Double Switch-UpDown – Connection EC	84B1Q32008EC17U

TIG Torch DVOH With Basic Torch Package

Position	Article Description	Order Number
	RA 320 W/4 m, Leather+Rubber, Handle-Double Switch – Connection EC	84BWQ32004EC17D
	RA 320 W/8 m, Leather+Rubber, Handle-Double Switch – Connection EC	84BWQ32008EC17D
	RA 320 W/4 m, Leather+Rubber, Handle-Double Switch-UpDown – Connection EC	84BWQ32004EC17U
	RA 320 W/8 m, Leather+Rubber, Handle-Double Switch-UpDown – Connection EC	84BWQ32008EC17U

Replacement Parts Torch Body

Position	Article Description	Order Number
1a	Torch Body RA 320 W	8560Q320
	Torch Body RA 320 WF flexible	8560Q322

Replacement Parts Handle

Position	Article Description	Order Number
	Handle SET Double Switch	8550317DD
	Handle SET Double Switch-UpDown	8550317UP
10a	Handle Pair (le+ri) Red	8550317Z1-1RT2
10c	Handle Bracket	8550304Z2-12
10d	Handle Micro Switch	8550317Z5-11
10ga	Handle Double Button	8550317Z4-21
10gb	Handle Switch UpDown Small	8550317Z4-312
10gc	Handle Switch UpDown Large	8550317Z4-311
10h	Handle Screw	8550317Z1-9

Replacement Parts Torch Package Highflex

Position	Article Description	Order Number
	Package/4 m, Leather+Rubber, G-Cu-W, RA 320 W	83B1P32004M10x1G#-U
	Package/8 m, Leather+Rubber, G-Cu-W, RA 320 W	83B1P32008M10x1G#-U
	Power Cable/4 m, Rubber-Cu-W, RA 320 W	821P32004M10x1G#
	Power Cable/8 m, Rubber-Cu-W, RA 320 W	821P32008M10x1G#
20a	Hose Overbraided Rubber 7x10 Black/Red	855130710SR
20b	Power Connector M8x1 RH Swivel Thread – 7 mm	85505521207R
20c	Ferrule A450L – Alu	85519A116
20d	Power Connector M10x1 RH Male Thread – 7 mm	85505522307R
21a	Hose Overbraided Rubber 4x6 Blue	855130406B
21b	1-Ear-Clamp with Innerlayer 8.3	855200083
22a	Hose Overbraided Rubber 4x6 Black	855130406S
22b	1-Ear-Clamp with Innerlayer 8.3	855200083
28	Control Cable LiYY-FD 7x0.25	855180107025FD
29	Cable Cover Sheath Rubber Ø23 mm	8551402310
	Leather Adapter Ø 22–28 mm (3-pcs)	8551002001
	Cable Cover Sheath/1 m Leather Ø 22 mm Black	85514Z0222

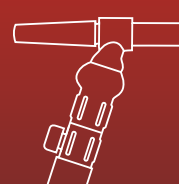
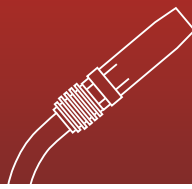
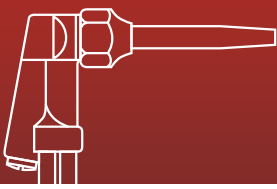

Spare Parts

Position	Article Description	Order Number
30a	Back Cap Short L=12 mm	85742913
30b	Back Cap Medium L=55 mm	85742930
30c	Back Cap Long L=152 mm	85742970
30d	O-Ring	8550908017R
41	Collet Ø 1.0 mm L=12.7 mm	85114441
	Collet Ø 1.6 mm L=12.7 mm	85114451
	Collet Ø 2.4 mm L=12.7 mm	85114461
	Collet Ø 3.2 mm L=12.7 mm	85114471
42	Chuck Ø 1.0 mm L=10.3 mm	85129614
	Chuck Ø 1.6 mm L=10.3 mm	85129615
	Chuck Ø 2.4 mm L=10.3 mm	85129616
	Chuck Ø 3.2 mm L=10.3 mm	85129617
52	Gas Lens Ø 1.6 mm L=12.5 mm	85131416
	Gas Lens Ø 2.4 mm L=12.5 mm	85131424
	Gas Lens Ø 3.2 mm L=12.5 mm	85131432
43a	Gas Nozzle Size 4 iØ 6.4 mm L=22 mm	85230015
	Gas Nozzle Size 5 iØ 8.0 mm L=22 mm	85231015
	Gas Nozzle Size 6 iØ 9.6 mm L=22 mm	85232015
	Gas Nozzle Size 7 iØ 11.2 mm L=22 mm	85233015
43b	Gas Nozzle Size 4 iØ 6.4 mm L=33 mm	85230115
	Gas Nozzle Size 5 iØ 8.0 mm L=33 mm	85231115
	Gas Nozzle Size 6 iØ 9.6 mm L=33 mm	85232115
	Gas Nozzle Size 7 iØ 11.2 mm L=33 mm	85233115



1.Q.4

A-Series RA 420 W



TIG Torch Package RA 420 W/RA 420 WF

Capacity at 60 % duty cycle (10 min. cycle):

Highflex torch package:	350 amps – DC – direct current 300 amps – AC – alternating current
DVOH torch package (reinforced):	400 amps – DC – direct current 360 amps – AC – alternating current

Type of cooling:	Water cooling
Wire diameter:	1.0–4.0 mm
Standard:	Conform to EN 60 974-7
Connection:	Suitable for any power supply in the market

RA 420 W, water cooled

Highflex torch package

350 A – DC – 60 % duty cycle

300 A – AC – 60 % duty cycle

DVOH torch package (reinforced)

400 A – DC – 60 % duty cycle

360 A – AC – 60 % duty cycle

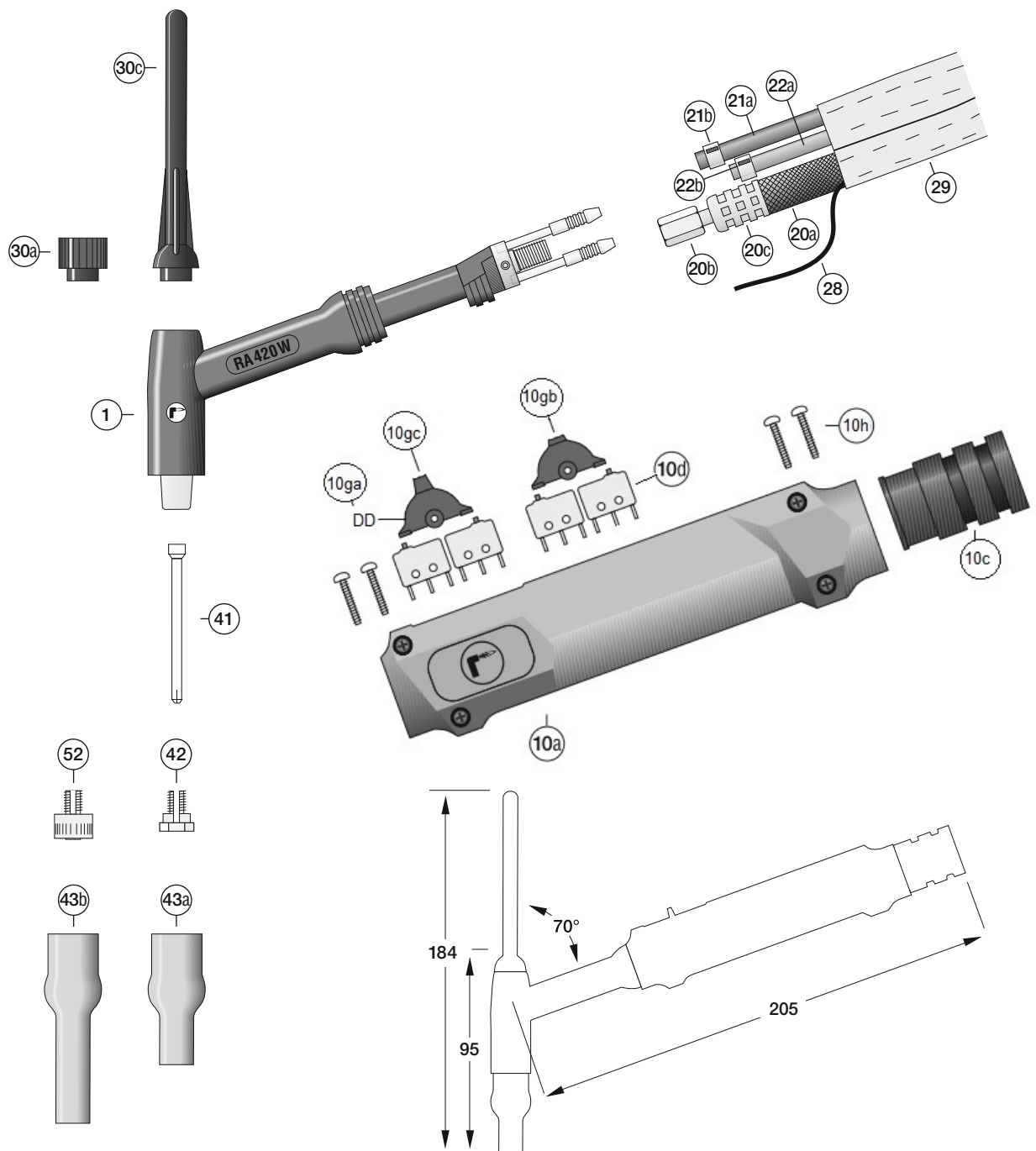



TIG Torch RA420W/RA420WF

TIG Torches Highflex With Basic Torch Package

Position	Article Description	Order Number
	RA 420 W/4 m, Leather+Rubber, Handle-Double Switch – Connection EC	84B1Q42004FA17D
	RA 420 W/8 m, Leather+Rubber, Handle-Double Switch – Connection EC	84B1Q42008FA17D
	RA 420 W/4 m, Leather+Rubber, Handle-Double Switch-UpDown – Connection EC	84B1Q42004FA17U
	RA 420 W/8 m, Leather+Rubber, Handle-Double Switch-UpDown – Connection EC	84B1Q42008FA17U

TIG Torch DVOH With Basic Torch Package

Position	Article Description	Order Number
	RA 420 W/4 m, Leather+Rubber, Handle-Double Switch – Connection EC	84BWQ42004EC17D
	RA 420 W/8 m, Leather+Rubber, Handle-Double Switch – Connection EC	84BWQ42008EC17D
	RA 420 W/4 m, Leather+Rubber, Handle-Double Switch-UpDown – Connection EC	84BWQ42004EC17U
	RA 420 W/8 m, Leather+Rubber, Handle-Double Switch-UpDown – Connection EC	84BWQ42008EC17U

Replacement Parts Torch Body

Position	Article Description	Order Number
1a	Torch Body RA 420 W	8560Q420
	Torch Body RA 420 WF flexible	8560Q422

Replacement Parts Handle

Position	Article Description	Order Number
	Handle SET Double Switch	8550317DD
	Handle SET Double Switch-UpDown	8550317UP
10a	Handle Pair (le+ri) Red	8550317Z1-1RT2
10c	Handle Bracket	8550304Z2-12
10d	Handle Micro Switch	8550317Z5-11
10ga	Handle Double Button	8550317Z4-21
10gb	Handle Switch UpDown Small	8550317Z4-312
10gc	Handle Switch UpDown Large	8550317Z4-311
10h	Handle Screw	8550317Z1-9

Replacement Parts Torch Package Highflex

Position	Article Description	Order Number
	Package/4 m, Leather+Rubber, G-Cu-W, RA 420 W	83B1P42004M10x1G#-U
	Package/8 m, Leather+Rubber, G-Cu-W, RA 420 W	83B1P42008M10x1G#-U
	Power Cable/4 m, Rubber, Strand-Cu, RA 420 W	821P42004M10x1G#
	Power Cable/8 m, Rubber, Strand-Cu, RA 420 W	821P42008M10x1G#
20a	Hose Overbraided Rubber 7x10 Black/Red	855130710SR
20b	Power Connector M8x1 RH Swivel Nut-L – 7 mm	85505521107R
20c	Ferrule A450L – Alu	85519A116
20d	Power Connector M10x1 RH Male Thread – 7 mm	85505522307R
21a	Hose Overbraided Rubber 4x6 Blue	855130406B
21b	1-Ear-Clamp with Innerlayer 8.3	855200083
22a	Hose Overbraided Rubber 4x6 Black	855130406S
22b	1-Ear-Clamp with Innerlayer 8.3	855200083
28	Control Cable LiYY-FD 7x0.25	855180107025FD
29a	Cable Cover Sheath Rubber Ø 23 mm	8551402310
29b	Leather Adapter Ø 22–28 mm (3-pcs)	8551002001
29c	Cable Cover Sheath/1 m Leather, Ø 28 mm Black	85514Z0228

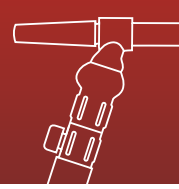
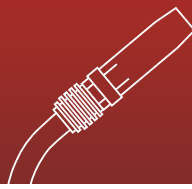
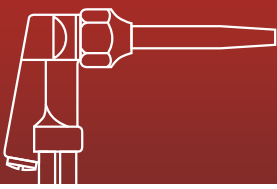

Spare Parts

Position	Article Description	Order Number
30a	Back Cap Short L=15 mm	85711132
30c	Back Cap Long L=103 mm	85711172
41	Collet Ø 1.0 mm L=59 mm	85119640
	Collet Ø 1.6 mm L=59 mm	85119650
	Collet Ø 2.4 mm L=59 mm	85119660
	Collet Ø 3.2 mm L=59 mm	85119670
	Collet Ø 4.0 mm L=59 mm	85119680
42	Chuck Ø 1.0 mm L=10.3 mm	85129614
	Chuck Ø 1.6 mm L=10.3 mm	85129615
	Chuck Ø 2.4 mm L=10.3 mm	85129616
	Chuck Ø 3.2 mm L=10.3 mm	85129617
	Chuck Ø 4.0 mm L=10.3 mm	85129618
52	Gas Lens Ø 1.6 mm L=12.5 mm	85131416
	Gas Lens Ø 2.4 mm L=12.5 mm	85131424
	Gas Lens Ø 3.2 mm L=12.5 mm	85131432
43a	Gas Nozzle Size 4 iØ 6.4 mm L=44 mm	85230005
	Gas Nozzle Size 5 iØ 8.0 mm L=44 mm	85231005
	Gas Nozzle Size 6 iØ 9.6 mm L=44 mm	85232005
	Gas Nozzle Size 7 iØ 11.2 mm L=44 mm	85233005
	Gas Nozzle Size 8 iØ 12.8 mm L=44 mm	85234005
	Gas Nozzle Size 9 iØ 14.4 mm L=44 mm	85235005
	Gas Nozzle Size 10 iØ 16.0 mm L=44 mm	85236005
43b	Gas Nozzle Size 4 iØ 6.4 mm L=64 mm	85230075
	Gas Nozzle Size 5 iØ 8.0 mm L=64 mm	85231075
	Gas Nozzle Size 6 iØ 9.6 mm L=64 mm	85232075
	Gas Nozzle Size 7 iØ 11.2 mm L=64 mm	85233075

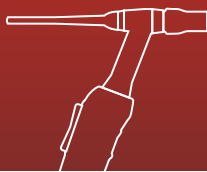

ROHRMAN
SCHWEISSTECHNIK

1.P.1

P-Series RP 160 L



TIG Torch Package RP 160 L/RP 160 LF

Capacity at 40 % duty cycle (10 min. cycle):

Highflex torch package: 125 amps – DC – direct current
80 amps – AC – alternating current

DVOH torch package (reinforced): 160 amps – DC – direct current
120 amps – AC – alternating current

Type of cooling: Air cooling

Wire diameter: 1.0–2.4 mm

Standard: Conform to EN 60 974-7

Connection: Suitable for any power supply in the market



RP 160 L, air cooled

Highflex torch package

125 A – DC – 40 % duty cycle
 80 A – AC – 40 % duty cycle

DVOH torch package (reinforced)

160 A – DC – 40 % duty cycle
 120 A – AC – 40 % duty cycle

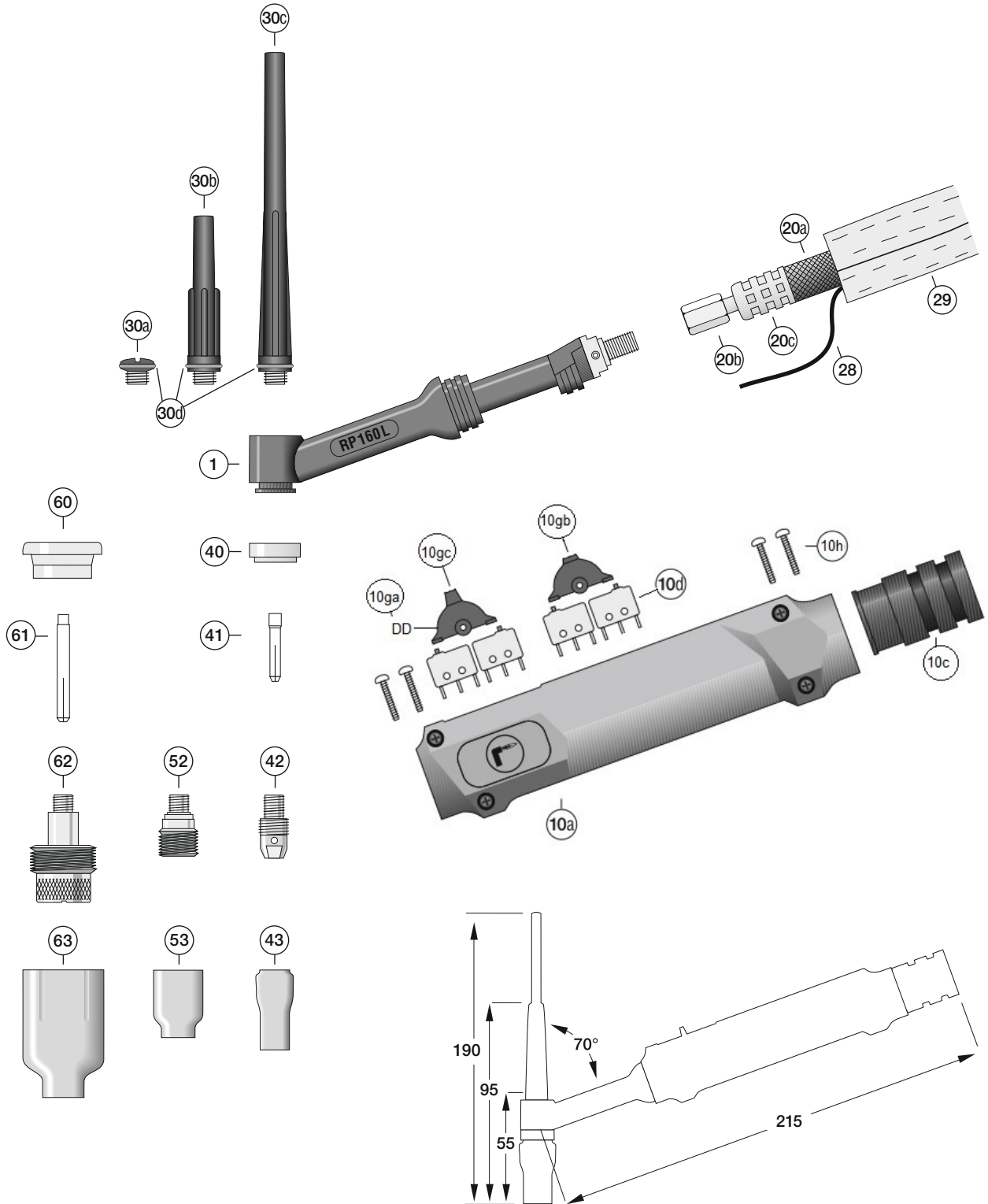



TIG Torch RP 160 L/RP 160 LF

TIG Torches Highflex With Basic Torch Package

Position	Article Description	Order Number
	RP 160 L/4 m, Leather+Rubber, Handle-Double Switch – Connection EC	84B1P16004EC17D
	RP 160 L/8 m, Leather+Rubber, Handle-Double Switch – Connection EC	84B1P16008EC17D
	RP 160 L/4 m, Leather+Rubber, Handle-Double Switch-UpDown – Connection EC	84B1P16004EC17U
	RP 160 L/8 m, Leather+Rubber, Handle-Double Switch-UpDown – Connection EC	84B1P16008EC17U

TIG Torch DVOH With Basic Torch Package

Position	Article Description	Order Number
	RP 160 L/4 m, Leather+Rubber, Handle-Double Switch – Connection EC	84BVP16004EC17D
	RP 160 L/8 m, Leather+Rubber, Handle-Double Switch – Connection EC	84BVP16008EC17D
	RP 160 L/4 m, Leather+Rubber, Handle-Double Switch-UpDown – Connection EC	84BVP16004EC17U
	RP 160 L/8 m, Leather+Rubber, Handle-Double Switch-UpDown – Connection EC	84BVP16008EC17U

Replacement Parts Torch Body

Position	Article Description	Order Number
1a	Torch Body RP 160 L	8560P160
	Torch Body RP 160 LF flexible	8560P162

Replacement Parts Handle

Position	Article Description	Order Number
	Handle SET Double Switch	8550317DD
	Handle SET Double Switch-UpDown	8550317UP
10a	Handle Pair (le+ri) Red	8550317Z1-1RT2
10c	Handle Bracket	8550304Z2-12
10d	Handle Micro Switch	8550317Z5-11
10ga	Handle Double Button	8550317Z4-21
10gb	Handle Switch UpDown Small	8550317Z4-312
10gc	Handle Switch UpDown Large	8550317Z4-311
10h	Handle Screw	8550317Z1-9

Replacement Parts Torch Package Highflex

Position	Article Description	Order Number
	Package/4 m, Leather+Rubber, G-Cu-W, RP 160 L	83B1P16004M10x1G#-U
	Package/8 m, Leather+Rubber, G-Cu-W, RP 160 L	83B1P16008M10x1G#-U
	Power Cable/4 m, Rubber, Strand-Cu, RP 160 L	821P16004M10x1G#
	Power Cable/8 m, Rubber, Strand-Cu, RP 160 L	821P16008M10x1G#
20a	Hose Overbraided Rubber 8x12 Black/Red	855130812SR
20b	Power Connector M8x1 RH Swivel Nut-L – 8 mm	85505521108R-L
20c	Ferrule A500L – Alu	85519A126
20d	Power Connector M10x1 RH Male Thread – 8 mm	85505522308R
28	Control Cable 7x0.25FD	855180107025FD
29	Hose Overbraided Rubber Ø 23 mm	8551402310
	Leather Adapter Ø 22–28 mm (3-pcs)	8551002001
	Cable Cover Sheath/1 m Leather Ø 22 mm Black	85514Z0222

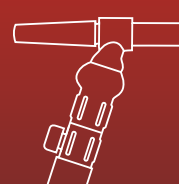
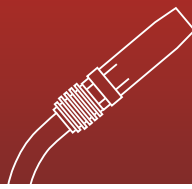
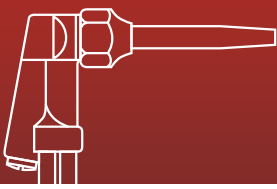

Spare Parts

Position	Article Description	Order Number
30a	Back Cap Short L=12 mm	85742913P
30b	Back Cap Medium L=55 mm	85742930P
30c	Back Cap Long L=152 mm	85742970P
30d	O-Ring	8550908017R
40	Insulator	85504820
41	Collet Ø 0.5 mm L=25 mm	85113200
	Collet Ø 1.0 mm L=25 mm	85113210
	Collet Ø 1.6 mm L=25 mm	85113220
	Collet Ø 2.4 mm L=25 mm	85113230
	Collet Ø 3.2 mm L=25 mm	85113240
42	Collet Body Ø 0.5 mm L=21 mm	85123250
	Collet Body Ø 1.0 mm L=21 mm	85123260
	Collet Body Ø 1.6 mm L=21 mm	85123270
	Collet Body Ø 2.4 mm L=21 mm	85123280
	Collet Body Ø 3.2 mm L=21 mm	85123290
43	Gas Nozzle Size 4 Ø 6.4 mm L=29 mm	85213080
	Gas Nozzle Size 5 Ø 8.0 mm L=29 mm	85213090
	Gas Nozzle Size 6 Ø 9.6 mm L=29 mm	85213100
	Gas Nozzle Size 7 Ø 11.2 mm L=29 mm	85213110
	Gas Nozzle Size 8 Ø 12.5 mm L=29 mm	85213120
	Gas Nozzle Size 10 Ø 16.0 mm L=29 mm	85213130
52	Gas Lens Standard Ø 0.5 mm L=22 mm	85134541
	Gas Lens Standard Ø 1.0 mm L=22 mm	85134542
	Gas Lens Standard Ø 1.6 mm L=22 mm	85134543
	Gas Lens Standard Ø 2.4 mm L=22 mm	85134544
	Gas Lens Standard Ø 3.2 mm L=22 mm	85134545
53	Gas Nozzle Size 4 Ø 6.4 mm L=25 mm	85253580
	Gas Nozzle Size 5 Ø 8.0 mm L=25 mm	85253590
	Gas Nozzle Size 6 Ø 9.6 mm L=25 mm	85253600
	Gas Nozzle Size 7 Ø 11.2 mm L=25 mm	85253610
	Gas Nozzle Size 8 Ø 12.5 mm L=25 mm	85253612
60	Insulator Jumbo	85504632
61	Collet Jumbo Ø 0.5 mm L=40 mm	85113204
	Collet Jumbo Ø 1.0 mm L=40 mm	85113214
	Collet Jumbo Ø 1.6 mm L=40 mm	85113224
	Collet Jumbo Ø 2.4 mm L=40 mm	85113234
	Collet Jumbo Ø 3.2 mm L=40 mm	85113244
62	Collet Jumbo Ø 0.5 – 1.0 mm L=41 mm	85136504
	Gas Lens Jumbo Ø 1.6 mm L=41 mm	85136516
	Gas Lens Jumbo Ø 2.4 mm L=41 mm	85136564
	Gas Lens Jumbo Ø 3.2 mm L=41 mm	85136795
63	Gas Nozzle Jumbo Size 6 Ø 9.6 mm L=48 mm	85257750
	Gas Nozzle Jumbo Size 8 Ø 12.8 mm L=48 mm	85257740
	Gas Nozzle Jumbo Size 10 Ø 16.0 mm L=48 mm	85253880
	Gas Nozzle Jumbo Size 12 Ø 19.6 mm L=48 mm	85253870



ROHRMAN
SCHWEISSTECHNIK

1.P.2

P-Series RP 220 L



TIG Torch Package RP 220 L/RP 220 LF

Capacity at 40 % duty cycle (10 min. cycle):

Highflex torch package:	180 amps – DC – direct current
	130 amps – AC – alternating current
DVOH torch package (reinforced):	220 amps – DC – direct current
	180 amps – AC – alternating current

Type of cooling: Air cooling

Wire diameter: 1.0–3.2 mm

Standard: Conform to EN 60 974-7

Connection: Suitable for any power supply in the market



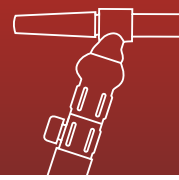
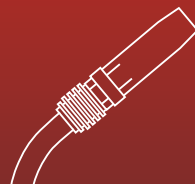
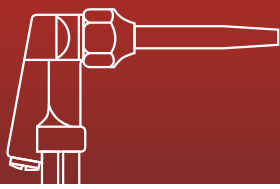

RP 220 L, air cooled

Highflex torch package

180 A – DC – 40 % duty cycle

130 A – AC – 40 % duty cycle

DVOH torch package (reinforced)

220 A – DC – 40 % duty cycle

180 A – AC – 40 % duty cycle

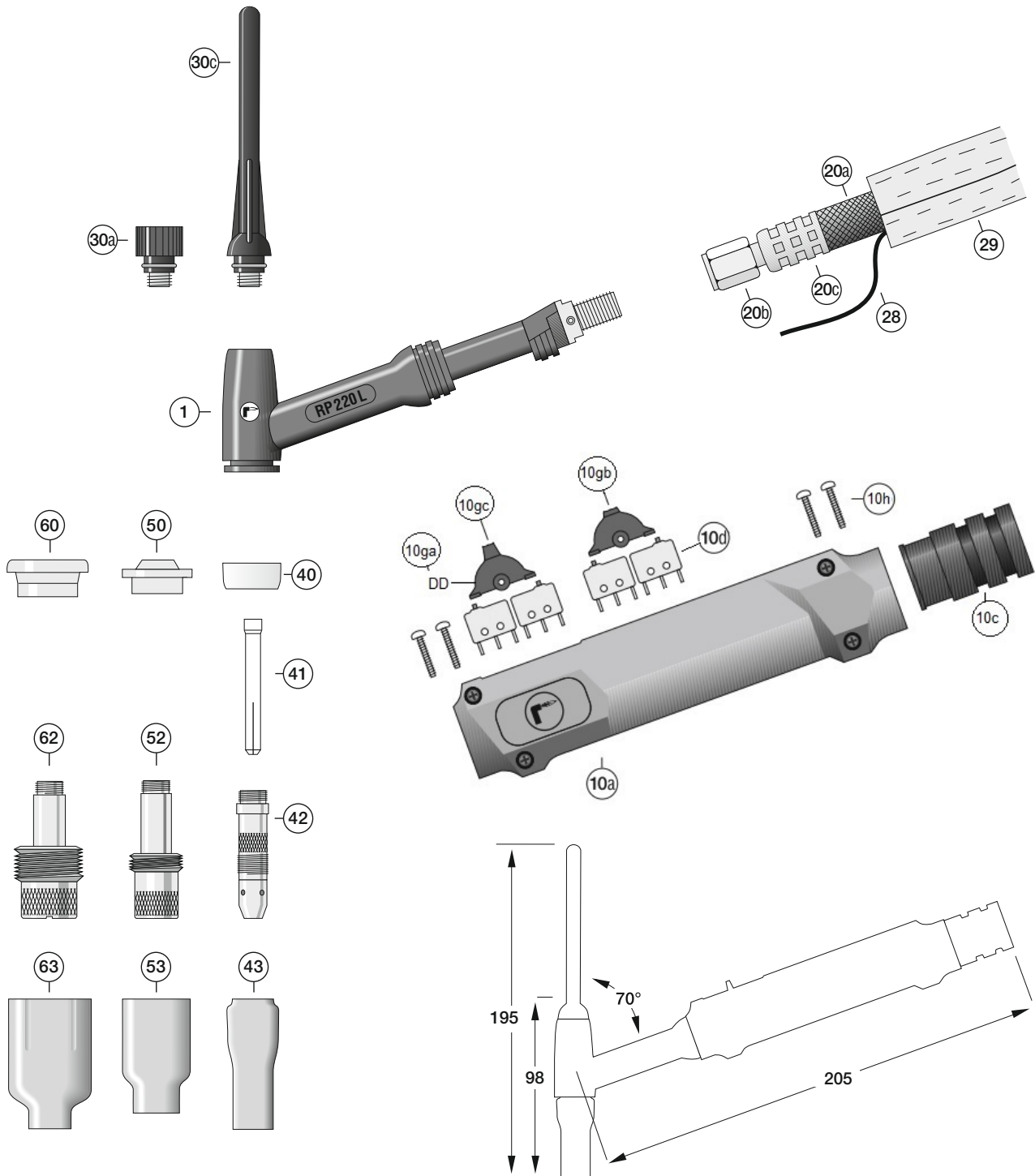



TIG Torch RP 220 L/RP 220 LF

TIG Torches Highflex With Basic Torch Package

Position	Article Description	Order Number
	RP 220 L/4 m, Leather+Rubber, Handle-Double Switch – Connection EC	84B1P22004EC17D
	RP 220 L/8 m, Leather+Rubber, Handle-Double Switch – Connection EC	84B1P22008EC17D
	RP 220 L/4 m, Leather+Rubber, Handle-Double Switch-UpDown – Connection EC	84B1P22004EC17U
	RP 220 L/8 m, Leather+Rubber, Handle-Double Switch-UpDown – Connection EC	84B1P22008EC17U

TIG Torch DVOH With Basic Torch Package

Position	Article Description	Order Number
	RP 220 L/4 m, Leather+Rubber, Handle-Double Switch – Connection EC	84BVP22004EC17D
	RP 220 L/8 m, Leather+Rubber, Handle-Double Switch – Connection EC	84BVP22008EC17D
	RP 220 L/4 m, Leather+Rubber, Handle-Double Switch-UpDown – Connection EC	84BVP22004EC17U
	RP 220 L/8 m, Leather+Rubber, Handle-Double Switch-UpDown – Connection EC	84BVP22008EC17U

Replacement Parts Torch Body

Position	Article Description	Order Number
1a	Torch Body RP 220 L	8560P220
	Torch Body RP 220 LF flexible	8560P222

Replacement Parts Handle

Position	Article Description	Order Number
	Handle SET Double Switch	8550317DD
	Handle SET Double Switch-UpDown	8550317UP
10a	Handle Pair (le+ri) Red	8550317Z1-1RT2
10c	Handle Bracket	8550304Z2-12
10d	Handle Micro Switch	8550317Z5-11
10ga	Handle Double Button	8550317Z4-21
10gb	Handle Switch UpDown Small	8550317Z4-312
10gc	Handle Switch UpDown Large	8550317Z4-311
10h	Handle Screw	8550317Z1-9

Replacement Parts Torch Package Highflex

Position	Article Description	Order Number
	Package/4 m, Leather+Rubber, G-Cu-W, RP 220 L	83B1P22004M10x1G#-U
	Package/8 m, Leather+Rubber, G-Cu-W, RP 220 L	83B1P22008M10x1G#-U
	Power Cable/4 m, Rubber-Cu-W, RP 220 L	821P22004M10x1G#
	Power Cable/8 m, Rubber-Cu-W, RP 220 L	821P22008M10x1G#
20a	Hose Overbraided Rubber 10x14 Black/Red	855131014SR
20b	Power Connection M10x1 RH Swivel Nut-L – 10 mm	85505522110R-L
20c	Ferrule A575L – Alu	85519A146
20d	Power Connection M10x1 RH Male Thread – 10 mm	85505522310R
28	Control Cable LiYY-FD 7x0.25	855180107025FD
29	Hose Overbraided Rubber Ø 23 mm	8551402310
	Leather Adapter Ø 22–28 mm (3-pcs)	8551002001
	Cable Cover Sheath/1 m Leather Ø 22 mm Black	85514Z0222

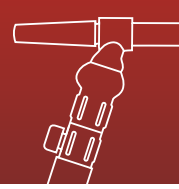
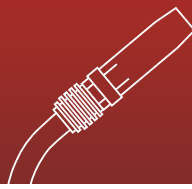
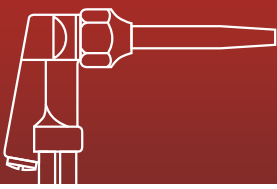

Spare Parts

Position	Article Description	Order Number
30a	Back Cap Short L=27,5 mm	85754041
30c	Back Cap Long L=120 mm	85754021
30d	O-Ring	
40	Insulator Standard	85504188
41	Collet Ø 0.5 mm L=50 mm	85110210
	Collet Ø 1.0 mm L=50 mm	85110220
	Collet Ø 1.6 mm L=50 mm	85110230
	Collet Ø 2.4 mm L=50 mm	85110240
	Collet Ø 3.2 mm L=50 mm	85110250
	Collet Ø 4.0 mm L=50 mm	85114200
42	Collet Body Ø 0.5 mm L=47 mm	85120290
	Collet Body Ø 1.0 mm L=47 mm	85120300
	Collet Body Ø 1.6 mm L=47 mm	85120310
	Collet Body Ø 2.4 mm L=47 mm	85120320
	Collet Body Ø 3.2 mm L=47 mm	85120280
	Collet Body Ø 4.0 mm L=47 mm	85124880
43	Gas Nozzle Size 4 Ø 6.4 mm L=47 mm	85210500
	Gas Nozzle Size 5 Ø 8.0 mm L=47 mm	85210490
	Gas Nozzle Size 6 Ø 9.6 mm L=47 mm	85210480
	Gas Nozzle Size 7 Ø 11.2 mm L=47 mm	85210470
	Gas Nozzle Size 8 Ø 12.5 mm L=47 mm	85210460
	Gas Nozzle Size 10 Ø 16.0 mm L=47 mm	85210450
	Gas Nozzle Size 12 Ø 19.2 mm L=47 mm	85210440
50	Insulator Adapter	85504010
52	Gas Lens Standard Ø 0.5 mm L=50 mm	85134529
	Gas Lens Standard Ø 1.0 mm L=50 mm	85134524
	Gas Lens Standard Ø 1.6 mm L=50 mm	85134525
	Gas Lens Standard Ø 2.4 mm L=50 mm	85134526
	Gas Lens Standard Ø 3.2 mm L=50 mm	85134527
	Gas Lens Standard Ø 4.0 mm L=50 mm	85134528
53	Gas Nozzle Size 4 Ø 6.4 mm L=42 mm	85254180
	Gas Nozzle Size 5 Ø 8.0 mm L=42 mm	85254170
	Gas Nozzle Size 6 Ø 9.6 mm L=42 mm	85254160
	Gas Nozzle Size 7 Ø 11.2 mm L=42 mm	85254150
	Gas Nozzle Size 8 Ø 12.5 mm L=42 mm	85254140
	Gas Nozzle Size 10 Ø 16.0 mm L=42 mm	85254140-10
	Gas Nozzle Size 12 Ø 19.2 mm L=42 mm	85254140-12
60	Insulator Jumbo	85504630
	Gas Lens Jumbo Ø 0.5-1.0 mm L=50 mm	85134502
	Gas Lens Jumbo Ø 1.6 mm L=50 mm	85134516
	Gas Lens Jumbo Ø 2.4 mm L=50 mm	85134564
	Gas Lens Jumbo Ø 3.2 mm L=50 mm	85135795
	Gas Lens Jumbo Ø 4.0 mm L=50 mm	85134563
63	Gas Nozzle Jumbo Size 6 Ø 9.6 mm L=48 mm	85257750
	Gas Nozzle Jumbo Size 8 Ø 12.5 mm L=48 mm	85257740
	Gas Nozzle Jumbo Size 10 Ø 16.0 mm L=48 mm	85253880
	Gas Nozzle Jumbo Size 12 Ø 19.2 mm L=48 mm	85253870

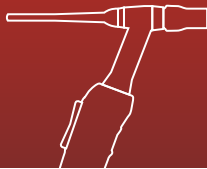

ROHRMAN
SCHWEISSTECHNIK

1.P.3

P-Series RP 320 W



TIG Torch Package RP 320 W/RP 320 WF

Capacity at 60 % duty cycle (10 min. cycle):

Highflex torch package:	250 amps – DC – direct current 200 amps – AC – alternating current
DVOH torch package (reinforced):	300 amps – DC – direct current 250 amps – AC – alternating current

Type of cooling:	Water cooling
Wire diameter:	1.0–3.2 mm
Standard:	Conform to EN 60 974-7
Connection:	Suitable for any power supply in the market

RP 320 W, water cooled

Highflex torch package
 250 A – DC – 60 % duty cycle
 200 A – AC – 60 % duty cycle

DVOH torch package (reinforced)
 300 A – DC – 60 % duty cycle
 250 A – AC – 60 % duty cycle

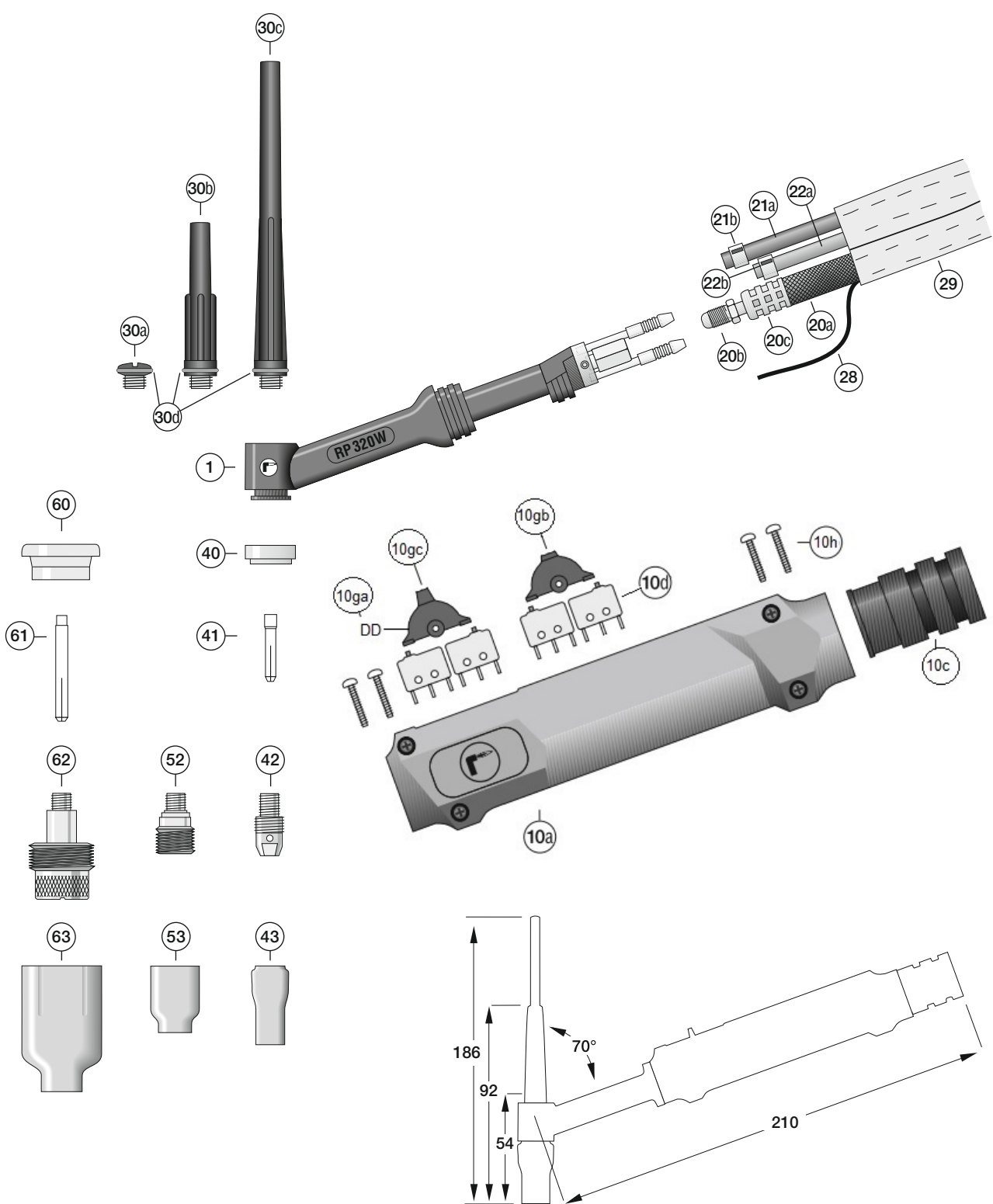



TIG Torch RP 320 W/RP 320 WF

TIG Torches Highflex With Basic Torch Package

Position	Article Description	Order Number
	RP 320 W/4 m, Leather+Rubber, Handle-Double Switch – Connection EC	84B1P32004EC17D
	RP 320 W/8 m, Leather+Rubber, Handle-Double Switch – Connection EC	84B1P32008EC17D
	RP 320 W/4 m, Leather+Rubber, Handle-Double Switch-UpDown – Connection EC	84B1P32004EC17U
	RP 320 W/8 m, Leather+Rubber, Handle-Double Switch-UpDown – Connection EC	84B1P32008EC17U

TIG Torch DVOH With Basic Torch Package

Position	Article Description	Order Number
	RP 320 W/4 m, Leather+Rubber, Handle-Double Switch – Connection EC	84BWP32004EC17D
	RP 320 W/8 m, Leather+Rubber, Handle-Double Switch – Connection EC	84BWP32008EC17D
	RP 320 W/4 m, Leather+Rubber, Handle-Double Switch-UpDown – Connection EC	84BWP32004EC17U
	RP 320 W/8 m, Leather+Rubber, Handle-Double Switch-UpDown – Connection EC	84BWP32008EC17U

Replacement Parts Torch Body

Position	Article Description	Order Number
1a	Torch Body RP 320 W	8560P320
	Torch Body RP 320 WF flexible	8560P322

Replacement Parts Handle

Position	Article Description	Order Number
	Handle SET Double Switch	8550317DD
	Handle SET Double Switch-UpDown	8550317UP
10a	Handle Pair (le+ri) Red	8550317Z1-1RT2
10c	Handle Bracket	8550304Z2-12
10d	Handle Micro Switch	8550317Z5-11
10ga	Handle Double Button	8550317Z4-21
10gb	Handle Switch UpDown Small	8550317Z4-312
10gc	Handle Switch UpDown Large	8550317Z4-311
10h	Handle Screw	8550317Z1-9

Replacement Parts Torch Package Highflex

Position	Article Description	Order Number
	Package/4 m, Leather+Rubber, G-Cu-W, RP 320 W	83B1P32004M10x1G#-U
	Package/8 m, Leather+Rubber, G-Cu-W, RP 320 W	83B1P32008M10x1G#-U
	Power Cable/4 m, Rubber-Cu-W, RP 320 W	821P32004M10x1G#
	Power Cable/8 m, Rubber-Cu-W, RP 320 W	821P32008M10x1G#
20a	Hose Overbraided Rubber 7x10 Black/Red	855130710SR
20b	Power Connection M8x1 RH Swivel Thread – 7 mm	85505521207R
20c	Ferrule A450L – Alu	85519A116
20d	Power Connection M10x1 RH Male Thread – 7 mm	85505522307R
21a	Hose Overbraided Rubber 4x6 Blue	855130406B
21b	1-Ear-Clamp with Innerlayer 8.3	855200083
22a	Hose Overbraided Rubber 4x6 Black	855130406S
22b	1-Ear-Clamp with Innerlayer 8.3	855200083
28	Control Cable LiYY-FD 7x0.25	855180107025FD
29a	Hose Overbraided Rubber Ø 23 mm	8551402310
29b	Leather Adapter Ø 22–28 mm (3-pcs)	8551002001
29c	Cable Cover Sheath/1 m Leather Ø 22 mm Black	85514Z0222

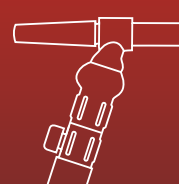
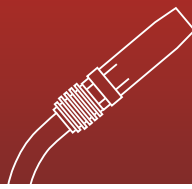
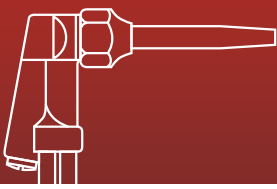

Spare Parts

Position	Article Description	Order Number
30a	Back Cap Short L=12 mm	85742913P
30b	Back Cap Medium L=55 mm	85742930P
30c	Back Cap Long L=152 mm	85742970P
30d	O-Ring	8550908017R
40	Insulator	85504820
41	Collet Ø 0.5 mm L=25 mm	85113200
	Collet Ø 1.0 mm L=25 mm	85113210
	Collet Ø 1.6 mm L=25 mm	85113220
	Collet Ø 2.4 mm L=25 mm	85113230
	Collet Ø 3.2 mm L=25 mm	85113240
42	Collet Body Ø 0.5 mm L=21 mm	85123250
	Collet Body Ø 1.0 mm L=21 mm	85123260
	Collet Body Ø 1.6 mm L=21 mm	85123270
	Collet Body Ø 2.4 mm L=21 mm	85123280
	Collet Body Ø 3.2 mm L=21 mm	85123290
43	Gas Nozzle Size 4 Ø 6.4 mm L=29 mm	85213080
	Gas Nozzle Size 5 Ø 8.0 mm L=29 mm	85213090
	Gas Nozzle Size 6 Ø 9.6 mm L=29 mm	85213100
	Gas Nozzle Size 7 Ø 11.2 mm L=29 mm	85213110
	Gas Nozzle Size 8 Ø 12.5 mm L=29 mm	85213120
	Gas Nozzle Size 10 Ø 16.0 mm L=29 mm	85213130
52	Gas Lens Standard Ø 0.5 mm L=22 mm	85134541
	Gas Lens Standard Ø 1.0 mm L=22 mm	85134542
	Gas Lens Standard Ø 1.6 mm L=22 mm	85134543
	Gas Lens Standard Ø 2.4 mm L=22 mm	85134544
	Gas Lens Standard Ø 3.2 mm L=22 mm	85134545
53	Gas Nozzle Size 4 Ø 6.4 mm L=25 mm	85253580
	Gas Nozzle Size 5 Ø 8.0 mm L=25 mm	85253590
	Gas Nozzle Size 6 Ø 9.6 mm L=25 mm	85253600
	Gas Nozzle Size 7 Ø 11.2 mm L=25 mm	85253610
	Gas Nozzle Size 8 Ø 12.5 mm L=25 mm	85253612
60	Insulator Jumbo	85504632
61	Collet Jumbo Ø 0.5 mm L=40 mm	85113204
	Collet Jumbo Ø 1.0 mm L=40 mm	85113214
	Collet Jumbo Ø 1.6 mm L=40 mm	85113224
	Collet Jumbo Ø 2.4 mm L=40 mm	85113234
	Collet Jumbo Ø 3.2 mm L=40 mm	85113244
62	Gas Lens Jumbo Ø 0.5–1.0 mm L=41 mm	85136504
	Gas Lens Jumbo Ø 1.6 mm L=41 mm	85136516
	Gas Lens Jumbo Ø 2.4 mm L=41 mm	85136564
	Gas Lens Jumbo Ø 3.2 mm L=41 mm	85136795
63	Gas Nozzle Jumbo Size 6 Ø 9.6 mm L=48 mm	85257750
	Gas Nozzle Jumbo Size 8 Ø 12.8 mm L=48 mm	85257740
	Gas Nozzle Jumbo Size 10 Ø 16.0 mm L=48 mm	85253880
	Gas Nozzle Jumbo Size 12 Ø 19.6 mm L=48 mm	85253870



1.P.4

P-Series RP 420 W



TIG Torch Package RP 420 W/RP 420 WF

Capacity at 60 % duty cycle (10 min. cycle):

Highflex torch package:	350 amps – DC – direct current 300 amps – AC – alternating current
DVOH torch package (reinforced):	400 amps – DC – direct current 360 amps – AC – alternating current

Type of cooling: Air cooling

Wire diameter: 1.0–4.0 mm

Standard: Conform to EN 60 974-7

Connection: Suitable for any power supply in the market

RP 420 W, water cooled

Highflex torch package

350 A – DC – 60 % duty cycle

300 A – AC – 60 % duty cycle

DVOH torch package (reinforced)

400 A – DC – 60 % duty cycle

360 A – AC – 60 % duty cycle

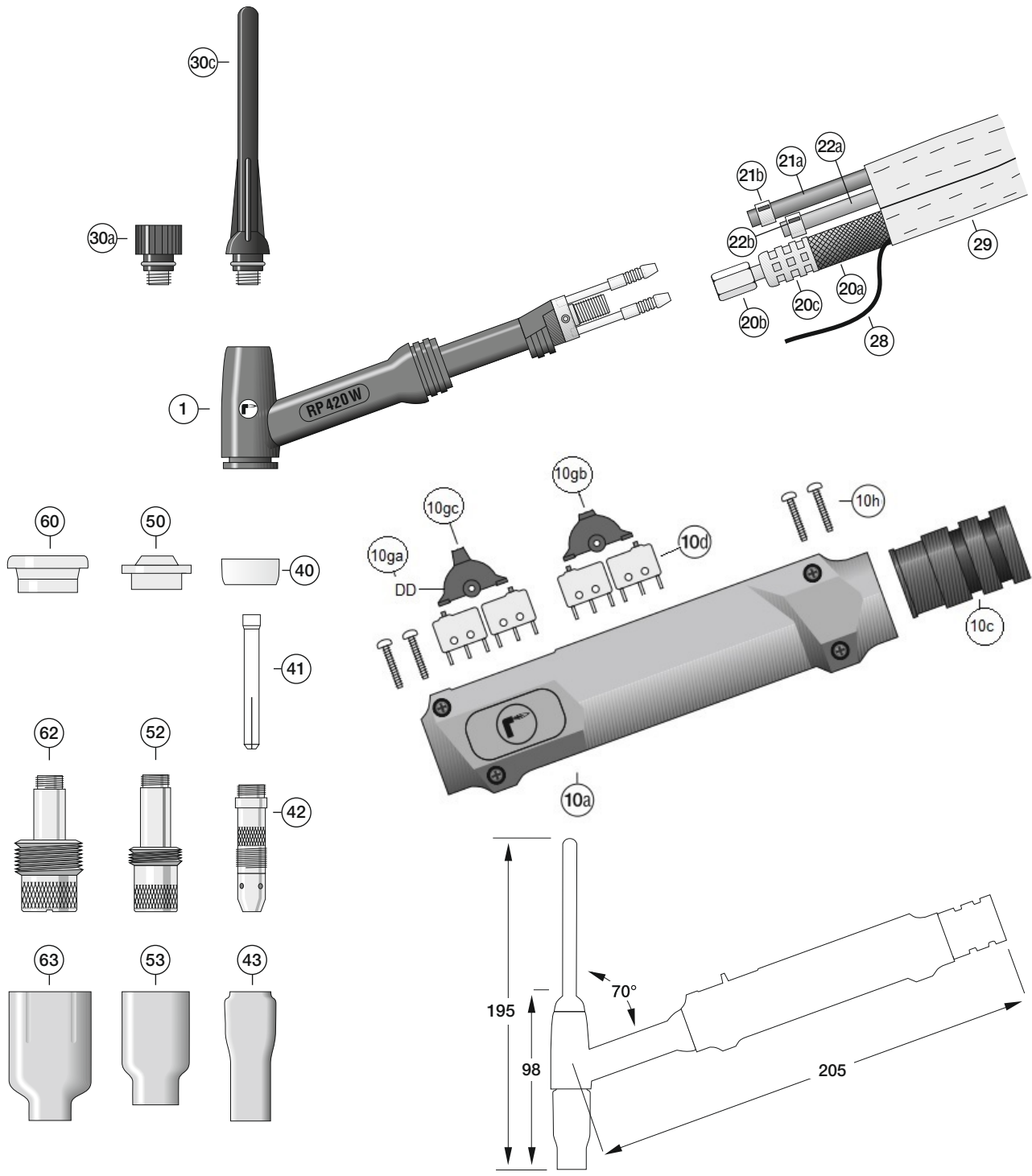



TIG Torch RP 420 W/RP 420 WF

TIG Torches Highflex With Basic Torch Package

Position	Article Description	Order Number
	RP 420 W/4 m, Leather+Rubber, Handle-Double Switch – Connection EC	84B1P42004EC17D
	RP 420 W/8 m, Leather+Rubber, Handle-Double Switch – Connection EC	84B1P42008EC17D
	RP 420 W/4 m, Leather+Rubber, Handle-Double Switch-UpDown – Connection EC	84B1P42004EC17U
	RP 420 W/8 m, Leather+Rubber, Handle-Double Switch-UpDown – Connection EC	84B1P42008EC17U

TIG Torch DVOH With Basic Torch Package

Position	Article Description	Order Number
	RP 420 W/4 m, Leather+Rubber, Handle-Double Switch – Connection EC	84B1P42004EC17D
	RP 420 W/8 m, Leather+Rubber, Handle-Double Switch – Connection EC	84B1P42008EC17D
	RP 420 W/4 m, Leather+Rubber, Handle-Double Switch-UpDown – Connection EC	84B1P42004EC17U
	RP 420 W/8 m, Leather+Rubber, Handle-Double Switch-UpDown – Connection EC	84B1P42008EC17U

Replacement Parts Torch Body

Position	Article Description	Order Number
1a	Torch Body RP 420 W	8560P420
	Torch Body RP 420 WF flexible	8560P422

Replacement Parts Handle

Position	Article Description	Order Number
	Handle SET Double Switch	8550317DD
	Handle SET Double Switch-UpDown	8550317UP
10a	Handle Pair (le+ri) Red	8550317Z1-1RT2
10c	Handle Bracket	8550304Z2-12
10d	Handle Micro Switch	8550317Z5-11
10ga	Handle Double Button	8550317Z4-21
10gb	Handle Switch UpDown Small	8550317Z4-312
10gc	Handle Switch UpDown Large	8550317Z4-311
10h	Handle Screw	8550317Z1-9

Replacement Parts Torch Package Highflex

Position	Article Description	Order Number
	Package/4 m, Leather+Rubber, G-Cu-W, RP 420 W	83B1P42004M10x1G#-U
	Package/8 m, Leather+Rubber, G-Cu-W, RP 420 W	83B1P42008M10x1G#-U
	Power Cable/4 m, Rubber, Strand-Cu, RP 420 W	821P42004M10x1G#
	Power Cable/8 m, Rubber, Strand-Cu, RP 420 W	821P42008M10x1G#
20a	Hose Overbraided Rubber 7x10 Black/Red	855130710SR
20b	Power Connection M8x1 RH Swivel Nut-L – 7 mm	85505521107R
20c	Ferrule A450L – Alu	85519A116
20d	Power Connection M10x1 RH Male Thread – 7 mm	85505522307R
21a	Hose Overbraided Rubber 4x6 Blue	855130406B
21b	1-Ear-Clamp with Innerlayer 8.3	855200083
22a	Hose Overbraided Rubber 4x6 Black	855130406S
22b	1-Ear-Clamp with Innerlayer 8.3	855200083
28	Control Cable LiYY-FD 7x0.25	855180107025FD
29a	Hose Overbraided Rubber Ø 23 mm	8551402310
29b	Leather Adapter Ø 22–28 mm (3-pcs)	8551002001
29c	Cable Cover Sheath/1 m Leather Ø 28 mm Black	85514Z0228

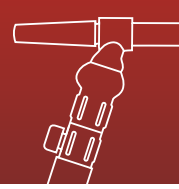
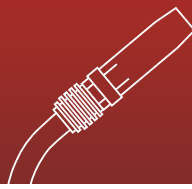
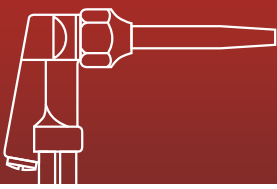

Spare Parts

Position	Article Description	Order Number
30a	Back Cap Short L=27.5 mm	85757041
30c	Back Cap Long L=120 mm	85757021
30d	O-Ring	
40	Insulator Standard	85504188
41	Collet Ø 0.5 mm L=50 mm	85110210
	Collet Ø 1.0 mm L=50 mm	85110220
	Collet Ø 1.6 mm L=50 mm	85110230
	Collet Ø 2.4 mm L=50 mm	85110240
	Collet Ø 3.2 mm L=50 mm	85110250
	Collet Ø 4.0 mm L=50 mm	85114200
42	Collet Body Ø 0.5 mm L=47 mm	85120290
	Collet Body Ø 1.0 mm L=47 mm	85120300
	Collet Body Ø 1.6 mm L=47 mm	85120310
	Collet Body Ø 2.4 mm L=47 mm	85120320
	Collet Body Ø 3.2 mm L=47 mm	85120280
	Collet Body Ø 4.0 mm L=47 mm	85124880
43	Gas Nozzle Size 4 Ø 6.4 mm L=47 mm	85210500
	Gas Nozzle Size 5 Ø 8.0 mm L=47 mm	85210490
	Gas Nozzle Size 6 Ø 9.6 mm L=47 mm	85210480
	Gas Nozzle Size 7 Ø 11.2 mm L=47 mm	85210470
	Gas Nozzle Size 8 Ø 12.5 mm L=47 mm	85210460
	Gas Nozzle Size 10 Ø 16.0 mm L=47 mm	85210450
	Gas Nozzle Size 12 Ø 19.2 mm L=47 mm	85210440
50	Insulator Adapter	85504010
52	Gas Lens Standard Ø 0.5 mm L=50 mm	85134529
	Gas Lens Standard Ø 1.0 mm L=50 mm	85134524
	Gas Lens Standard Ø 1.6 mm L=50 mm	85134525
	Gas Lens Standard Ø 2.4 mm L=50 mm	85134526
	Gas Lens Standard Ø 3.2 mm L=50 mm	85134527
	Gas Lens Standard Ø 4.0 mm L=50 mm	85134528
53	Gas Nozzle Size 4 Ø 6.4 mm L=42 mm	85254180
	Gas Nozzle Size 5 Ø 8.0 mm L=42 mm	85254170
	Gas Nozzle Size 6 Ø 9.6 mm L=42 mm	85254160
	Gas Nozzle Size 7 Ø 11.2 mm L=42 mm	85254150
	Gas Nozzle Size 8 Ø 12.5 mm L=42 mm	85254140
	Gas Nozzle Size 10 Ø 16.0 mm L=42 mm	85254140-10
	Gas Nozzle Size 12 Ø 19.2 mm L=42 mm	85254140-12
60	Insulator Jumbo	85504630
	Gas Lens Jumbo Ø 0.5-1.0 mm L=50 mm	85134502
	Gas Lens Jumbo Ø 1.6 mm L=50 mm	85134516
	Gas Lens Jumbo Ø 2.4 mm L=50 mm	85134564
	Gas Lens Jumbo Ø 3.2 mm L=50 mm	85135795
	Gas Lens Jumbo Ø 4.0 mm L=50 mm	85134563
63	Gas Nozzle Jumbo Size 6 Ø 9.6 mm L=48 mm	85257750
	Gas Nozzle Jumbo Size 8 Ø 12.5 mm L=48 mm	85257740
	Gas Nozzle Jumbo Size 10 Ø 16.0 mm L=48 mm	85253880
	Gas Nozzle Jumbo Size 12 Ø 19.2 mm L=48 mm	85253870



Torch Packages



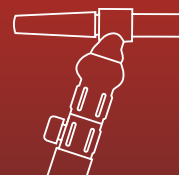
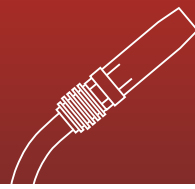
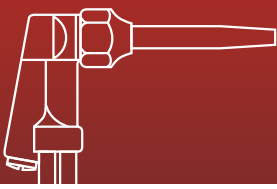

Torch Packages

RA 160 L / RP 160 L

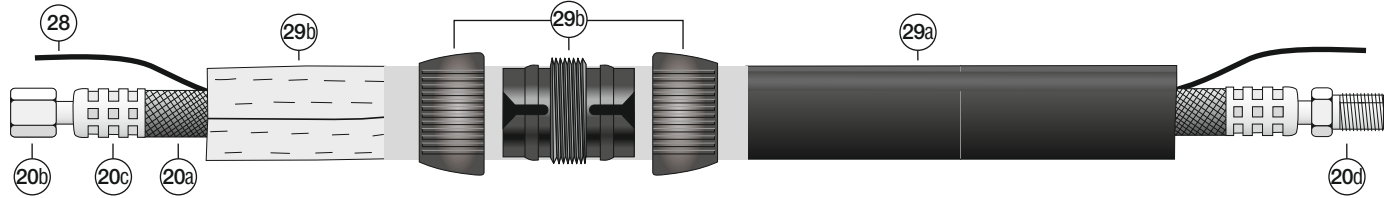

M8x1 right hand swivel nut

M10x1 right hand male thread

RA 220 L / RP 220 L

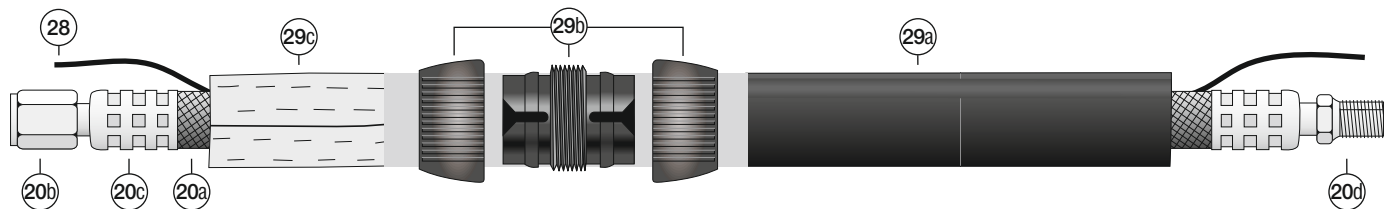

M8x1 right hand swivel nut

M10x1 right hand male thread

RA 320 W / RP 320 W

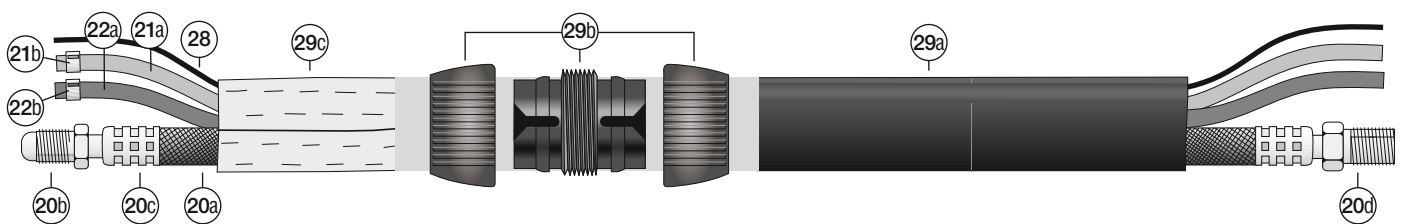

M8x1 right hand male thread

M10x1 right hand male thread

RA 420 W / RP 420 W

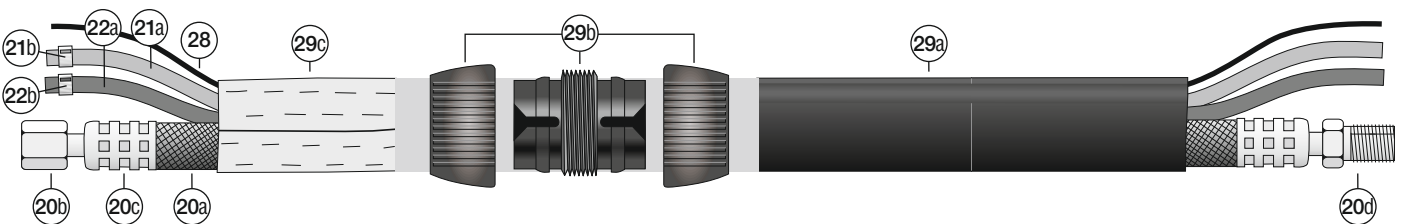

M8x1 right hand swivel nut

M10x1 right hand male thread



Torch Packages Highflex

Replacement Parts Highflex Air Cooled RA 160 L/RP 160 L

Position	Article Description	Order Number
	Package/4 m, Leather+Rubber, G-Cu-W, RA 160 L/RP 160 L	83B1P16004M10x1G#-U
	Package/8 m, Leather+Rubber, G-Cu-W, RA 160 L/RP 160 L	83B1P16008M10x1G#-U
	Power Cable/4 m, Rubber, Strand-Cu, RA 160 L/RP 160 L	821P16004M10x1G#
	Power Cable/8 m, Rubber, Strand-Cu, RA 160 L/RP 160 L	821P16008M10x1G#
20a	Hose Overbraided Rubber 8x12 Black/Red	855130812SR
20b	Power Connector M8x1 RH Swivel Nut-L – 8 mm	85505521108R-L
20c	Ferrule A500L – Alu	85519A126
20d	Power Connector M10x1 RH Male Thread – 8 mm	85505522308R
28	Control Cable 7x0.25FD	855180107025FD
29a	Hose Overbraided Rubber Ø 23 mm	8551402310
29b	Leather Adapter Ø 22–28 mm (3-pcs)	8551002001
29c	Cable Cover Sheath/1 m Leather Ø 22 mm Black	85514Z0222

Replacement Parts Highflex Air Cooled RA 220 L/RP 220 L

Position	Article Description	Order Number
	Package/4 m, Leather+Rubber, G-Cu-W, RA 220 L/RP 220 L	83B1P22004M10x1G#-U
	Package/8 m, Leather+Rubber, G-Cu-W, RA 220 L/RP 220 L	83B1P22008M10x1G#-U
	Power Cable/4 m, Rubber-Cu-W, RA 220 L/RP 220 L	821P22004M10x1G#
	Power Cable/8 m, Rubber-Cu-W, RA 220 L/RP 220 L	821P22008M10x1G#
20a	Hose Overbraided Rubber 10x14 Black/Red	855131014SR
20b	Power Connector M10x1 RH Swivel Nut-L – 10 mm	85505522110R-L
20c	Ferrule A575L – Alu	85519A146
20d	Power Connector M10x1 RH Male Thread – 10 mm	85505522310R
28	Control Cable LiYY-FD 7x0.25	855180107025FD
29a	Hose Overbraided Rubber Ø 23 mm	8551402310
29b	Leather Adapter Ø 22–28 mm (3-pcs)	8551002001
29c	Cable Cover Sheath/1 m Leather Ø 22 mm Black	85514Z0222

Replacement Parts Highflex Water Cooled RA 320 W/RP 320 W

Position	Article Description	Order Number
	Package/4 m, Leather+Rubber, G-Cu-W, RA 320 W/RP 320 W	83B1P32004M10x1G#-U
	Package/8 m, Leather+Rubber, G-Cu-W, RA 320 W/RP 320 W	83B1P32008M10x1G#-U
	Power Cable/4 m, Rubber-Cu-W, RA 320 W/RP 320 W	821P32004M10x1G#
	Power Cable/8 m, Rubber-Cu-W, RA 320 W/RP 320 W	821P32008M10x1G#
20a	Hose Overbraided Rubber 7x10 Black/Red	855130710SR
20b	Power Connector M8x1 RH Swivel Thread – 7 mm	85505521207R
20c	Ferrule A450L - Alu	85519A116
20d	Power Connector M10x1 RH Male Thread – 7 mm	85505522307R
21a	Hose Overbraided Rubber 4x6 Blue	855130406B
21b	1-Ear-Clamp with Innerlayer 8.3	855200083
22a	Hose Rubber 4x6 Black	855130406S
22b	1-Ear-Clamp with Innerlayer 8.3	855200083
28	Control Cable LiYY-FD 7x0.25	855180107025FD
29a	Hose Overbraided Rubber Ø 23 mm	8551402310
29b	Leather Adapter Ø 22–28 mm (3-pcs)	8551002001
29c	Cable Cover Sheath/1 m Leather Ø 22 mm Black	85514Z0222

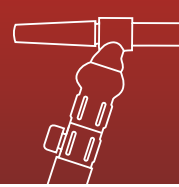
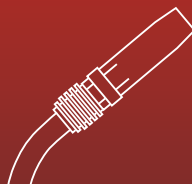
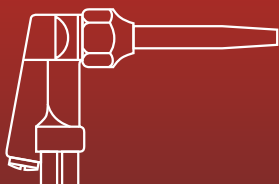

Replacement Parts Torch Package Highflex Water Cooled RA 420 W/RP 420 W

Position	Article Description	Order Number
	Package/4 m, Leather+Rubber, G-Cu-W, RA 420 W/RP 420 W	83B1P42004M10x1G#-U
	Package/8 m, Leather+Rubber, G-Cu-W, RA 420 W/RP 420 W	83B1P42008M10x1G#-U
	Power Cable/4 m, Rubber, Strand-Cu, RA 420 W/RP 420 W	821P42004M10x1G#
	Power Cable/8 m, Rubber, Strand-Cu, RA 420 W/RP 420 W	821P42008M10x1G#
20a	Hose Overbraided Rubber 7x10 Black/Red	855130710SR
20b	Power Connector M8x1 RH Swivel Nut-L – 7 mm	85505521107R
20c	Ferrule A450L – Alu	85519A116
20d	Power Connector M10x1 RH Male Thread – 7 mm	85505522307R
21a	Hose Overbraided Rubber 4x6 Blue	855130406B
21b	1-Ear-Clamp with Innerlayer 8.3	855200083
22a	Hose Overbraided Rubber 4x6 Black	855130406S
22b	1-Ear-Clamp with Innerlayer 8.3	855200083
28	Control Cable LiYY-FD 7x0.25	855180107025FD
29a	Hose Overbraided Rubber Ø 23 mm	8551402310
29b	Leather Adapter Ø 22–28 mm (3-pcs)	8551002001
29c	Cable Cover Sheath/1 m Leather Ø 28 mm Black	85514Z0228

Torch Package DVOH

Replacement Parts Torch Package DVOH Air Cooled RA 160 L/RP 160 L

Position	Article Description	Order Number
	Package/4 m, Leather+Rubber, DVOH-Cu-W, RA 160 L/RP 160 L	83BVP16004M10x1G#-U
	Package/8 m, Leather+Rubber, DVOH-Cu-W, RA 160 L/RP 160 L	83BVP16008M10x1G#-U
	Power Cable/4 m, DVOH, Strand-Cu, RA 160 L/RP 160 L	82VP16004M10x1G#
	Power Cable/8 m, DVOH, Strand-Cu, RA 160 L/RP 160 L	82VP16008M10x1G#
20a	Hose DVOH 9x11.6 mm	85513V0912RT
20b	Power Connector M8x1 RH Swivel Nut-L – 9 mm	85505521109R-L
20c	Ferrule A500L – Alu	85519A126
20d	Power Connector M10x1 RH Male Thread – 9 mm	85505522308R
28	Control Cable 7x0.25 FD	855180107025FD
29a	Hose Overbraided Rubber Ø 23 mm	8551402310
29b	Leather Adapter Ø 22–28 mm (3-pcs)	8551002001
29c	Cable Cover Sheath/1 m Leather Ø 22 mm Black	85514Z0222

Replacement Parts Torch Package DVOH Air Cooled RA 220 L/RP 220 L

Position	Article Description	Order Number
	Package/4 m, Leather+Rubber, G-Cu-W, RA 220 L/RP 220 L	83BVP22004M10x1G#-U
	Package/8 m, Leather+Rubber, G-Cu-W, RA 220 L/RP 220 L	83BVP22008M10x1G#-U
	Power Cable/4 m, Rubber-Cu-W, RA 220 L/RP 220 L	82VP22004M10x1G#
	Power Cable/8 m, Rubber-Cu-W, RA 220 L/RP 220 L	82VP22008M10x1G#
20a	Hose DVOH 10x12.5 mm	85513V1013RT
20b	Power Connector M10x1 RH Swivel Nut-L – 10 mm	85505522110R-L
20c	Ferrule A525L – Alu	85519A133
20d	Power Connector M10x1 RH Male Thread – 10 mm	85505522310R
28	Control Cable LiYY-FD 7x0.25	855180107025FD
29a	Hose Overbraided Rubber Ø 23 mm	8551402310
29b	Leather Adapter Ø 22–28 mm (3-pcs)	8551002001
29c	Cable Cover Sheath/1 m Leather Ø 22 mm Black	85514Z0222

**Replacement Parts Torch Package DVOH Water Cooled RA 320 W/RP 320 W**

Position	Article Description	Order Number
	Package/4 m, Leather+Rubber, G-Cu-W, RA 320 W/RP 320 W	83BWP32004M10x1G#-U
	Package/8 m, Leather+Rubber, G-Cu-W, RA 320 W/RP 320 W	83BWP32008M10x1G#-U
	Power Cable/4 m, Rubber-Cu-W, RA 320 W/RP 320 W	82WP32004M10x1G#
	Power Cable/8 m, Rubber-Cu-W, RA 320 W/RP 320 W	82WP32008M10x1G#
20a	Hose DVOH 8x10.2 mm	85513V0810RT
20b	Power Connector M8x1 RH Swivel Thread – 8 mm	85505521208R
20c	Ferrule A450L – Alu	85519A116
20d	Power Connector M10x1 RH Male Thread – 8 mm	85505522308R
21a	Hose DVOH 4x6.2 mm Blue	85513V0406BL
21b	1-Ear-Clamp with Innerlayer 8.3	855200083
22a	Hose PVC 4x7 Black	855120407
22b	1-Ear-Clamp with Innerlayer 8.3	855200083
28	Control Cable LiYY-FD 7x0.25	855180107025FD
29a	Hose Overbraided Rubber Ø 23 mm	8551402310
29b	Leather Adapter Ø 22–28 mm (3-pcs)	8551002001
29c	Cable Cover Sheath/1 m Leather Ø 22 mm Black	85514Z0222

Replacement Parts Torch Package DVOH Water Cooled RA 420 W/RP 420 W

Position	Article Description	Order Number
	Package/4 m, Leather+Rubber, G-Cu-W, RA 420 W/RP 420 W	83BWP42004M10x1G#-U
	Package/8 m, Leather+Rubber, G-Cu-W, RA 420 W/RP 420 W	83BWP42008M10x1G#-U
	Power Cable/4 m, Rubber, Strand-Cu, RA 420 W/RP 420 W	82WP42004M10x1G#
	Power Cable/8 m, Rubber, Strand-Cu, RA 420 W/RP 420 W	82WP42008M10x1G#
20a	Hose DVOH 9x11.6 mm	85513V0912RT
20b	Power Connector M8x1 RH Swivel Nut-L – 9 mm	85505521109R-L
20c	Hose A500L – Alu	85519A126
20d	Power Connector M10x1 RH Male Thread – 9 mm	85505522309R
21a	Hose DVOH 4x6.2 mm Blue	85513V0406BL
21b	1-Ear-Clamp with Innerlayer 8.3	855200083
22a	Hose PVC 4x7 Black	855120407
22b	1-Ear-Clamp with Innerlayer 8.3	855200083
28	Control Cable LiYY-FD 7x0.25	855180107025FD
29a	Hose Overbraided Rubber Ø 23 mm	8551402310
29b	Leather Adapter Ø 22–28 mm (3-pcs)	8551002001
29c	Cable Cover Sheath/1 m Leather Ø 28 mm Black	85514Z0228



Connections



FA - air cooled



FA - water cooled



FE - air cooled

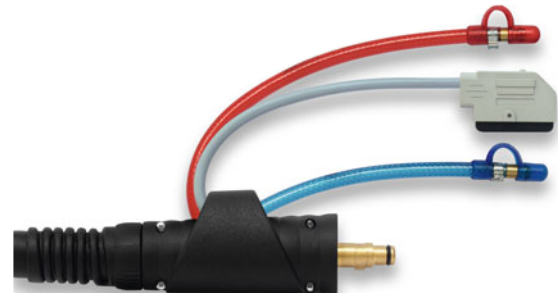

FE - water cooled



KR - air cooled



KR - water cooled



GC - air cooled



GC - water cooled

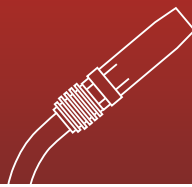
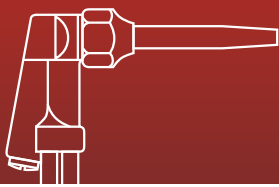

IG Torch Packages, Air Cooled, suitable to TIG power sources of the manufacturer “fronius” with connection FA

Article Description		Order Number
RA 160 L/4 m, Leather+Rubber, G-Cu-W, Handle-Double Switch	Connection FA	84B1Q16004FA17D
RA 160 L/8 m, Leather+Rubber, G-Cu-W, Handle-Double Switch	Connection FA	84B1Q16008FA17D
RA 160 L/4 m, Leather+Rubber, G-Cu-W, Handle-Double Switch-UpDown	Connection FA	84B1Q16004FA17U
RA 160 L/8 m, Leather+Rubber, G-Cu-W, Handle-Double Switch-UpDown	Connection FA	84B1Q16008FA17U
RA 220 L/4 m, Leather+Rubber, G-Cu-W, Handle-Double Switch	Connection FA	84B1Q22004FA17D
RA 220 L/8 m, Leather+Rubber, G-Cu-W, Handle-Double Switch	Connection FA	84B1Q22008FA17D
RA 220 L/4 m, Leather+Rubber, G-Cu-W, Handle-Double Switch-UpDown	Connection FA	84B1Q22004FA17U
RA 220 L/8 m, Leather+Rubber, G-Cu-W, Handle-Double Switch-UpDown	Connection FA	84B1Q22008FA17U
RP 160 L/4 m, Leather+Rubber, G-Cu-W, Handle-Double Switch	Connection FA	84B1P16004FA17D
RP 160 L/8 m, Leather+Rubber, G-Cu-W, Handle-Double Switch	Connection FA	84B1P16008FA17D
RP 160 L/4 m, Leather+Rubber, G-Cu-W, Handle-Double Switch-UpDown	Connection FA	84B1P16004FA17U
RP 160 L/8 m, Leather+Rubber, G-Cu-W, Handle-Double Switch-UpDown	Connection FA	84B1P16008FA17U
RP 220 L/4 m, Leather+Rubber, G-Cu-W, Handle-Double Switch	Connection FA	84B1P22004FA17D
RP 220 L/8 m, Leather+Rubber, G-Cu-W, Handle-Double Switch	Connection FA	84B1P22008FA17D
RP 220 L/4 m, Leather+Rubber, G-Cu-W, Handle-Double Switch-UpDown	Connection FA	84B1P22004FA17U
RP 220 L/8 m, Leather+Rubber, G-Cu-W, Handle-Double Switch-UpDown	Connection FA	84B1P22008FA17U

TIG Torch Packages, Water Cooled, suitable to TIG power sources of the manufacturer “fronius” with connection FA

Article Description		Order Number
RA 320 W/4 m, Leather+Rubber, G-Cu-W, Handle-Double Switch	Connection FA	84B1Q32004FA17D
RA 320 W/8 m, Leather+Rubber, G-Cu-W, Handle-Double Switch	Connection FA	84B1Q32008FA17D
RA 320 W/4 m, Leather+Rubber, G-Cu-W, Handle-Double Switch-UpDown	Connection FA	84B1Q32004FA17U
RA 320 W/8 m, Leather+Rubber, G-Cu-W, Handle-Double Switch-UpDown	Connection FA	84B1Q32008FA17U
RA 420 W/4 m, Leather+Rubber, G-Cu-W, Handle-Double Switch	Connection FA	84B1Q42004FA17D
RA 420 W/8 m, Leather+Rubber, G-Cu-W, Handle-Double Switch	Connection FA	84B1Q42008FA17D
RA 420 W/4 m, Leather+Rubber, G-Cu-W, Handle-Double Switch-UpDown	Connection FA	84B1Q42004FA17U
RA 420 W/8 m, Leather+Rubber, G-Cu-W, Handle-Double Switch-UpDown	Connection FA	84B1Q42008FA17U
RP 320 W/4 m, Leather+Rubber, G-Cu-W, Handle-Double Switch	Connection FA	84B1P32004FA17D
RP 320 W/8 m, Leather+Rubber, G-Cu-W, Handle-Double Switch	Connection FA	84B1P32008FA17D
RP 320 W/4 m, Leather+Rubber, G-Cu-W, Handle-Double Switch-UpDown	Connection FA	84B1P32004FA17U
RP 320 W/8 m, Leather+Rubber, G-Cu-W, Handle-Double Switch-UpDown	Connection FA	84B1P32008FA17U
RP 420 W/4 m, Leather+Rubber, G-Cu-W, Handle-Double Switch	Connection FA	84B1P42004FA17D
RP 420 W/8 m, Leather+Rubber, G-Cu-W, Handle-Double Switch	Connection FA	84B1P42008FA17D
RP 420 W/4 m, Leather+Rubber, G-Cu-W, Handle-Double Switch-UpDown	Connection FA	84B1P42004FA17U
RP 420 W/8 m, Leather+Rubber, G-Cu-W, Handle-Double Switch-UpDown	Connection FA	84B1P42008FA17U

**TIG Torch Packages, Air Cooled, suitable to TIG power sources of the manufacturer “fronius” with connection FE**

Article Description		Order Number
RA 160 L/4 m, Leather+Rubber, G-Cu, Handle-Double Switch	Connection FE	84B1Q16004FE17D
RA 160 L/8 m, Leather+Rubber, G-Cu, Handle-Double Switch	Connection FE	84B1Q16008FE17D
RA 160 L/4 m, Leather+Rubber, G-Cu, Handle-Double Switch-UpDown	Connection FE	84B1Q16004FE17U
RA 160 L/8 m, Leather+Rubber, G-Cu, Handle-Double Switch-UpDown	Connection FE	84B1Q16008FE17U
RA 220 L/4 m, Leather+Rubber, G-Cu, Handle-Double Switch	Connection FE	84B1Q22004FE17D
RA 220 L/8 m, Leather+Rubber, G-Cu, Handle-Double Switch	Connection FE	84B1Q22008FE17D
RA 220 L/4 m, Leather+Rubber, G-Cu, Handle-Double Switch-UpDown	Connection FE	84B1Q22004FE17U
RA 220 L/8 m, Leather+Rubber, G-Cu, Handle-Double Switch-UpDown	Connection FE	84B1Q22008FE17U
RP 160 L/4 m, Leather+Rubber, G-Cu, Handle-Double Switch	Connection FE	84B1P16004FE17D
RP 160 L/8 m, Leather+Rubber, G-Cu, Handle-Double Switch	Connection FE	84B1P16008FE17D
RP 160 L/4 m, Leather+Rubber, G-Cu, Handle-Double Switch-UpDown	Connection FE	84B1P16004FE17U
RP 160 L/8 m, Leather+Rubber, G-Cu, Handle-Double Switch-UpDown	Connection FE	84B1P16008FE17U
RP 220 L/4 m, Leather+Rubber, G-Cu, Handle-Double Switch	Connection FE	84B1P22004FE17D
RP 220 L/8 m, Leather+Rubber, G-Cu, Handle-Double Switch	Connection FE	84B1P22008FE17D
RP 220 L/4 m, Leather+Rubber, G-Cu, Handle-Double Switch-UpDown	Connection FE	84B1P22004FE17U
RP 220 L/8 m, Leather+Rubber, G-Cu, Handle-Double Switch-UpDown	Connection FE	84B1P22008FE17U

TIG Torch Packages, Water Cooled, suitable to TIG power sources of the manufacturer “fronius” with connection FE

Article Description		Order Number
RA 320 W/4 m, Leather+Rubber, G-Cu, Handle-Double Switch	Connection FE	84B1Q32004FE17D
RA 320 W/8 m, Leather+Rubber, G-Cu, Handle-Double Switch	Connection FE	84B1Q32008FE17D
RA 320 W/4 m, Leather+Rubber, G-Cu, Handle-Double Switch-UpDown	Connection FE	84B1Q32004FE17U
RA 320 W/8 m, Leather+Rubber, G-Cu, Handle-Double Switch-UpDown	Connection FE	84B1Q32008FE17U
RA 420 W/4 m, Leather+Rubber, G-Cu, Handle-Double Switch	Connection FE	84B1Q42004FE17D
RA 420 W/8 m, Leather+Rubber, G-Cu, Handle-Double Switch	Connection FE	84B1Q42008FE17D
RA 420 W/4 m, Leather+Rubber, G-Cu, Handle-Double Switch-UpDown	Connection FE	84B1Q42004FE17U
RA 420 W/8 m, Leather+Rubber, G-Cu, Handle-Double Switch-UpDown	Connection FE	84B1Q42008FE17U
RP 320 W/4 m, Leather+Rubber, G-Cu, Handle-Double Switch	Connection FE	84B1P32004FE17D
RP 320 W/8 m, Leather+Rubber, G-Cu, Handle-Double Switch	Connection FE	84B1P32008FE17D
RP 320 W/4 m, Leather+Rubber, G-Cu, Handle-Double Switch-UpDown	Connection FE	84B1P32004FE17U
RP 320 W/8 m, Leather+Rubber, G-Cu, Handle-Double Switch-UpDown	Connection FE	84B1P32008FE17U
RP 420 W/4 m, Leather+Rubber, G-Cu, Handle-Double Switch	Connection FE	84B1P42004FE17D
RP 420 W/8 m, Leather+Rubber, G-Cu, Handle-Double Switch	Connection FE	84B1P42008FE17D
RP 420 W/4 m, Leather+Rubber, G-Cu, Handle-Double Switch-UpDown	Connection FE	84B1P42004FE17U
RP 420 W/8 m, Leather+Rubber, G-Cu, Handle-Double Switch-UpDown	Connection FE	84B1P42008FE17U

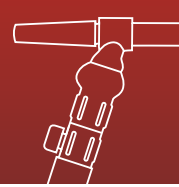
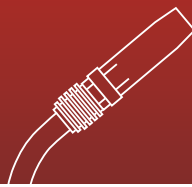
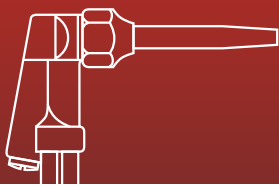

TIG Torch Packages, Air Cooled, suitable to TIG power sources of the manufacturer “castolin” with connection GC

Article Description		Order Number
RA 160 L/4 m, Leather+Rubber, G-Cu-W, Handle-Double Switch	Connection GC	84B1Q16004GC17D
RA 160 L/8 m, Leather+Rubber, G-Cu-W, Handle-Double Switch	Connection GC	84B1Q16008GC17D
RA 160 L/4 m, Leather+Rubber, G-Cu-W, Handle-Double Switch-UpDown	Connection GC	84B1Q16004GC17U
RA 160 L/8 m, Leather+Rubber, G-Cu-W, Handle-Double Switch-UpDown	Connection GC	84B1Q16008GC17U
RA 220 L/4 m, Leather+Rubber, G-Cu-W, Handle-Double Switch	Connection GC	84B1Q22004GC17D
RA 220 L/8 m, Leather+Rubber, G-Cu-W, Handle-Double Switch	Connection GC	84B1Q22008GC17D
RA 220 L/4 m, Leather+Rubber, G-Cu-W, Handle-Double Switch-UpDown	Connection GC	84B1Q22004GC17U
RA 220 L/8 m, Leather+Rubber, G-Cu-W, Handle-Double Switch-UpDown	Connection GC	84B1Q22008GC17U
RP 160 L/4 m, Leather+Rubber, G-Cu-W, Handle-Double Switch	Connection GC	84B1P16004GC17D
RP 160 L/8 m, Leather+Rubber, G-Cu-W, Handle-Double Switch	Connection GC	84B1P16008GC17D
RP 160 L/4 m, Leather+Rubber, G-Cu-W, Handle-Double Switch-UpDown	Connection GC	84B1P16004GC17U
RP 160 L/8 m, Leather+Rubber, G-Cu-W, Handle-Double Switch-UpDown	Connection GC	84B1P16008GC17U
RP 220 L/4 m, Leather+Rubber, G-Cu-W, Handle-Double Switch	Connection GC	84B1P22004GC17D
RP 220 L/8 m, Leather+Rubber, G-Cu-W, Handle-Double Switch	Connection GC	84B1P22008GC17D
RP 220 L/4 m, Leather+Rubber, G-Cu-W, Handle-Double Switch-UpDown	Connection GC	84B1P22004GC17U
RP 220 L/8 m, Leather+Rubber, G-Cu-W, Handle-Double Switch-UpDown	Connection GC	84B1P22008GC17U

TIG Torch Packages, Water Cooled, suitable to TIG power sources of the manufacturer “castolin” with connection GC

Article Description		Order Number
RA 320 W/4 m, Leather+Rubber, G-Cu-W, Handle-Double Switch	Connection GC	84B1Q32004GC17D
RA 320 W/8 m, Leather+Rubber, G-Cu-W, Handle-Double Switch	Connection GC	84B1Q32008GC17D
RA 320 W/4 m, Leather+Rubber, G-Cu-W, Handle-Double Switch-UpDown	Connection GC	84B1Q32004GC17U
RA 320 W/8 m, Leather+Rubber, G-Cu-W, Handle-Double Switch-UpDown	Connection GC	84B1Q32008GC17U
RA 420 W/4 m, Leather+Rubber, G-Cu-W, Handle-Double Switch	Connection GC	84B1Q42004GC17D
RA 420 W/8 m, Leather+Rubber, G-Cu-W, Handle-Double Switch	Connection GC	84B1Q42008GC17D
RA 420 W/4 m, Leather+Rubber, G-Cu-W, Handle-Double Switch-UpDown	Connection GC	84B1Q42004GC17U
RA 420 W/8 m, Leather+Rubber, G-Cu-W, Handle-Double Switch-UpDown	Connection GC	84B1Q42008GC17U
RP 320 W/4 m, Leather+Rubber, G-Cu-W, Handle-Double Switch	Connection GC	84B1P32004GC17D
RP 320 W/8 m, Leather+Rubber, G-Cu-W, Handle-Double Switch	Connection GC	84B1P32008GC17D
RP 320 W/4 m, Leather+Rubber, G-Cu-W, Handle-Double Switch-UpDown	Connection GC	84B1P32004GC17U
RP 320 W/8 m, Leather+Rubber, G-Cu-W, Handle-Double Switch-UpDown	Connection GC	84B1P32008GC17U
RP 420 W/4 m, Leather+Rubber, G-Cu-W, Handle-Double Switch	Connection GC	84B1P42004GC17D
RP 420 W/8 m, Leather+Rubber, G-Cu-W, Handle-Double Switch	Connection GC	84B1P42008GC17D
RP 420 W/4 m, Leather+Rubber, G-Cu-W, Handle-Double Switch-UpDown	Connection GC	84B1P42004GC17U
RP 420 W/8 m, Leather+Rubber, G-Cu-W, Handle-Double Switch-UpDown	Connection GC	84B1P42008GC17U

**TIG Torch Packages, Air Cooled, suitable to TIG power sources of the manufacturer “castolin” with connection KR**

Article Description		Order Number
RA 160 L/4 m, Leather+Rubber, G-Cu, Handle-Double Switch	Connection KR	84B1Q16004KR17D
RA 160 L/8 m, Leather+Rubber, G-Cu, Handle-Double Switch	Connection KR	84B1Q16008KR17D
RA 160 L/4 m, Leather+Rubber, G-Cu, Handle-Double Switch-UpDown	Connection KR	84B1Q16004KR17U
RA 160 L/8 m, Leather+Rubber, G-Cu, Handle-Double Switch-UpDown	Connection KR	84B1Q16008KR17U
RA 220 L/4 m, Leather+Rubber, G-Cu, Handle-Double Switch	Connection KR	84B1Q22004KR17D
RA 220 L/8 m, Leather+Rubber, G-Cu, Handle-Double Switch	Connection KR	84B1Q22008KR17D
RA 220 L/4 m, Leather+Rubber, G-Cu, Handle-Double Switch-UpDown	Connection KR	84B1Q22004KR17U
RA 220 L/8 m, Leather+Rubber, G-Cu, Handle-Double Switch-UpDown	Connection KR	84B1Q22008KR17U
RP 160 L/4 m, Leather+Rubber, G-Cu, Handle-Double Switch	Connection KR	84B1P16004KR17D
RP 160 L/8 m, Leather+Rubber, G-Cu, Handle-Double Switch	Connection KR	84B1P16008KR17D
RP 160 L/4 m, Leather+Rubber, G-Cu, Handle-Double Switch-UpDown	Connection KR	84B1P16004KR17U
RP 160 L/8 m, Leather+Rubber, G-Cu, Handle-Double Switch-UpDown	Connection KR	84B1P16008KR17U
RP 220 L/4 m, Leather+Rubber, G-Cu, Handle-Double Switch	Connection KR	84B1P22004KR17D
RP 220 L/8 m, Leather+Rubber, G-Cu, Handle-Double Switch	Connection KR	84B1P22008KR17D
RP 220 L/4 m, Leather+Rubber, G-Cu, Handle-Double Switch-UpDown	Connection KR	84B1P22004KR17U
RP 220 L/8 m, Leather+Rubber, G-Cu, Handle-Double Switch-UpDown	Connection KR	84B1P22008KR17U

TIG Torches, Water Cooled, suitable to TIG power sources of the manufacturer “castolin” with connection KR

Article Description		Order Number
RA 320 W/4 m, Leather+Rubber, G-Cu, Handle-Double Switch	Connection KR	84B1Q32004KR17D
RA 320 W/8 m, Leather+Rubber, G-Cu, Handle-Double Switch	Connection KR	84B1Q32008KR17D
RA 320 W/4 m, Leather+Rubber, G-Cu, Handle-Double Switch-UpDown	Connection KR	84B1Q32004KR17U
RA 320 W/8 m, Leather+Rubber, G-Cu, Handle-Double Switch-UpDown	Connection KR	84B1Q32008KR17U
RA 420 W/4 m, Leather+Rubber, G-Cu, Handle-Double Switch	Connection KR	84B1Q42004KR17D
RA 420 W/8 m, Leather+Rubber, G-Cu, Handle-Double Switch	Connection KR	84B1Q42008KR17D
RA 420 W/4 m, Leather+Rubber, G-Cu, Handle-Double Switch-UpDown	Connection KR	84B1Q42004KR17U
RA 420 W/8 m, Leather+Rubber, G-Cu, Handle-Double Switch-UpDown	Connection KR	84B1Q42008KR17U
RP 320 W/4 m, Leather+Rubber, G-Cu, Handle-Double Switch	Connection KR	84B1P32004KR17D
RP 320 W/8 m, Leather+Rubber, G-Cu, Handle-Double Switch	Connection KR	84B1P32008KR17D
RP 320 W/4 m, Leather+Rubber, G-Cu, Handle-Double Switch-UpDown	Connection KR	84B1P32004KR17U
RP 320 W/8 m, Leather+Rubber, G-Cu, Handle-Double Switch-UpDown	Connection KR	84B1P32008KR17U
RP 420 W/4 m, Leather+Rubber, G-Cu, Handle-Double Switch	Connection KR	84B1P42004KR17D
RP 420 W/8 m, Leather+Rubber, G-Cu, Handle-Double Switch	Connection KR	84B1P42008KR17D
RP 420 W/4 m, Leather+Rubber, G-Cu, Handle-Double Switch-UpDown	Connection KR	84B1P42004KR17U
RP 420 W/8 m, Leather+Rubber, G-Cu, Handle-Double Switch-UpDown	Connection KR	84B1P42008KR17U

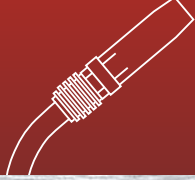

ROHRMAN
SCHWEISSTECHNIK

GE 07/12 SCHARF GRAFIKDESIGN

For more information contact your local welding supply distributor.



Rohrman Schweißtechnik GmbH
Kränkelsweg 34a - 41748 Viersen

Tel.: +49(0)2162 / 10 60 65-0
Fax: +49(0)2162 / 10 60 65-55

www.rohrman.de
info@rohrman.de

