



Datenblatt

Quarz Düse

WeldTec

WT-9, -20, -25

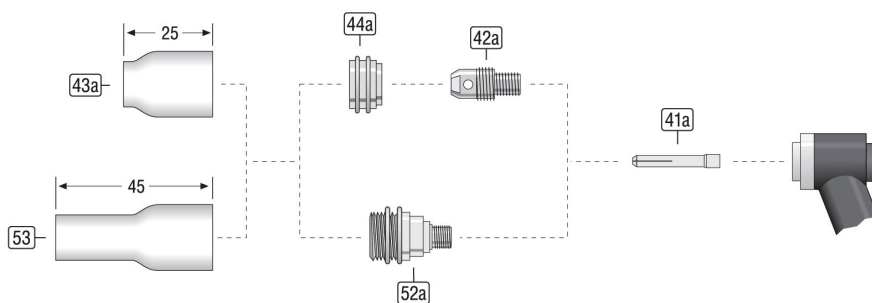

WT-17, -18, -26

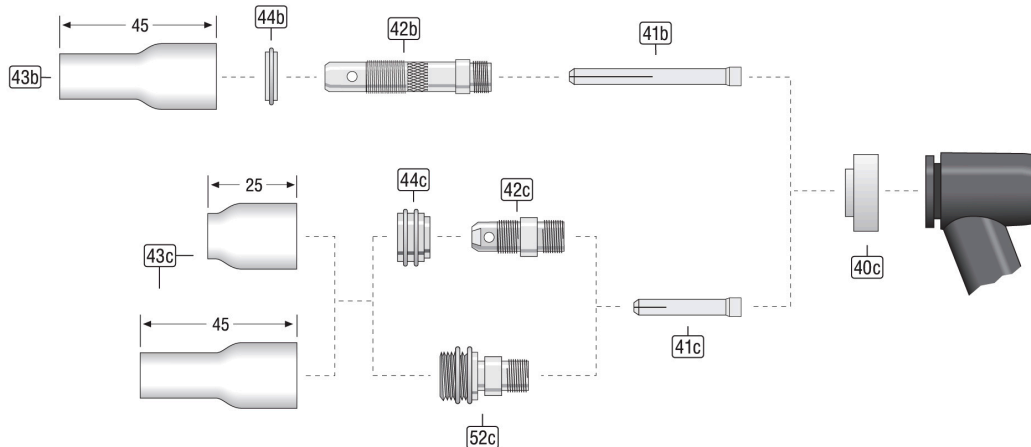

WT-24

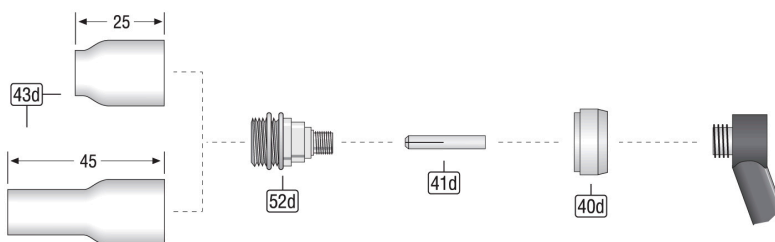

Verschleißteile WT9,20,25, I-Head, SW320, 320SA

Pos.	Artikelbezeichnung	Artikel
	Box Quarz Düse Ø1,6/2,4/3,2mm WT-9/20 SW-320	859-QN-20B
	Set Ø1,6mm Spannhülsegehäuse WT-9/20/25 SW-320	859-QN-20-16
	Set Ø2,4mm Spannhülsegehäuse WT-9/20/25 SW-320	859-QN-20-24
	Set Ø3,2mm Spannhülsegehäuse WT-9/20/25 SW-320	859-QN-20-32
	Set Ø1,6mm Gaslinse WT-9/20/25 SW-320	859-QN-20-16G
	Set Ø2,4mm Gaslinse WT-9/20/25 SW-320	859-QN-20-24G
	Set Ø3,2mm Gaslinse WT-9/20/25 SW-320	859-QN-20-32G
	Set Ø1,6mm Gaslinse Düse L WT-9/20/25 SW-320	859-QN-20-16GL
	Set Ø2,4mm Gaslinse Düse L WT-9/20/25 SW-320	859-QN-20-24GL
	Set Ø3,2mm Gaslinse Düse L WT-9/20/25 SW-320	859-QN-20-32GL
41a	Spannhülse Ø1,0mm L=25mm [13N21] WT-9/20/25 SW-320 WT-22/23	85113210-W
	Spannhülse Ø1,6mm L=25mm [13N22] WT-9/20/25 SW-320 WT-22/23	85113220-W
	Spannhülse Ø2,4mm L=25mm [13N23] WT-9/20/25 SW-320 WT-22/23	85113230-W
	Spannhülse Ø3,2mm L=25mm [13N24] WT-9/20/25 SW-320 WT-22/23	85113240-W
42a	Spannhülsegehäuse Ø1,0mm [13N26] WT-9/20/25 SW-320 WT-22/23	85123260-W
	Spannhülsegehäuse Ø1,6mm [13N27] WT-9/20/25 SW-320 WT-22/23	85123270-W
	Spannhülsegehäuse Ø2,4mm [13N28] WT-9/20/25 SW-320 WT-22/23	85123280-W
	Spannhülsegehäuse Ø3,2mm [13N29] WT-9/20/25 SW-320 WT-22/23	85123290-W
44a	Adapter Ring Spannhülsegehäuse [13NQA] WT-9/20/25 SW-320	859-QN20A
43a	Glasdüse Gr.5 [13NQ-5] WT-9/20/24/25 SW-320	859-QN050
	Glasdüse Gr.7 [13NQ-7] WT-9/20/24/25 SW-320	859-QN070
	Glasdüse Gr.9 [13NQ-9] WT-9/20/24/25 SW-320	859-QN090
52a	Gaslinse Ø1,6mm [45V43NQ] WT-9/20/24/25 SW-320	859-QN20-16G
	Gaslinse Ø2,4mm [45V44NQ] WT-9/20/24/25 SW-320	859-QN20-24G
	Gaslinse Ø3,2mm [45V45NQ] WT-9/20/24/25 SW-320	859-QN20-32G
53	Glasdüse Gr.5L [13NQ-5L] WT-9/20/24/25 SW-320	859-QN05L
	Glasdüse Gr.7L [13NQ-7L] WT-17/18/26	859-QN07L
	Glasdüse Gr.9L [13NQ-9L] WT-17/18/26	859-QN09L

Verschleißteile WT17,18,26 I-Head

Pos.	Artikelbezeichnung	Artikel
	Box Quarz Düse Ø1,6/2,4/3,2mm WT-17/18/26 SW-418	859-QN-17B
	Set Ø1,6mm Spannhülsegehäuse WT-17/18/26 SW-418	859-QN-17-16
	Set Ø2,4mm Spannhülsegehäuse WT-17/18/26 SW-418	859-QN-17-24
	Set Ø3,2mm Spannhülsegehäuse WT-17/18/26 SW-418	859-QN-17-32
	Set Ø1,6mm Gaslinse Stubby WT-17/18/26 SW-418	859-QN-17-16GS
	Set Ø2,4mm Gaslinse Stubby WT-17/18/26 SW-418	859-QN-17-24GS
	Set Ø3,2mm Gaslinse Stubby WT-17/18/26 SW-418	859-QN-17-32GS
	Set Ø1,6mm Spannhülsegehäuse Stubby WT-17/18/26 SW-418	859-QN-17-16S
	Set Ø2,4mm Spannhülsegehäuse Stubby WT-17/18/26 SW-418	859-QN-17-24S
	Set Ø3,2mm Spannhülsegehäuse Stubby WT-17/18/26 SW-418	859-QN-17-32S
40c	Isolator [10NQG] WT-17/18/26	859-QN17I
41b	Spannhülse Ø1,0mm L=50mm [10N22] WT-17/18/26 WT-28/29	85110220-W
	Spannhülse Ø1,6mm L=50mm [10N23] WT-17/18/26 WT-28/29	85110230-W
	Spannhülse Ø2,4mm L=50mm [10N24] WT-17/18/26 WT-28/29	85110240-W
	Spannhülse Ø3,2mm L=50mm [10N25] WT-17/18/26 WT-28/29	85110250-W
42b	Spannhülsegehäuse Ø1,0mm [10N30] WT-17/18/26 WT-28/29	85120300-W
	Spannhülsegehäuse Ø1,6mm [10N31] WT-17/18/26 WT-28/29	85120310-W
	Spannhülsegehäuse Ø2,4mm [10N32] WT-17/18/26 WT-28/29	85120320-W
	Spannhülsegehäuse Ø3,2mm [10N28] WT-17/18/26 WT-28/29	85120280-W
44b	Adapter Ring Spannhülsegehäuse [10NQA] WT-17/18/26	859-QN17A
43b	Glasdüse Gr.7L [10NQ-7L] WT-17/18/26	859-QN07L
	Glasdüse Gr.9L [10NQ-9L] WT-17/18/26	859-QN09L
41c	Spannhülse Ø1,6mm L=29,5mm [10N23S] WT-17/18/26 WT-28/29	85110231-W
	Spannhülse Ø2,4mm L=29,5mm [10N24S] WT-17/18/26 WT-28/29	85110241-W
	Spannhülse Ø3,2mm L=29,5mm [10N25S] WT-17/18/26 WT-28/29	85110251-W
42c	Spannhülsegehäuse Ø1,0-3,2mm [17CB20] WT-17/18/26 WT-28/29	85122000-W
44c	Adapter Ring Spannhülsegehäuse [13NQA] WT-9/20/25 SW-320	859-QN20A
52c	Gaslinse Ø1,6mm [17GL116] WT-17/18/26	85131716-W
	Gaslinse Ø2,4mm [17GL332] WT-17/18/26	85131724-W
	Gaslinse Ø3,2mm [17GL18] WT-17/18/26	85131732-W
43c	Glasdüse Gr.5 [13NQ-5] WT-9/20/24/25 SW-320	859-QN050

Nachdruck und Weitergabe in jeder Form - auch auszugsweise- ohne schriftliche Erlaubnis verboten.

© Rohrman Schweißtechnik GmbH - Viersen - Germany - www.rohrman.de - info@rohrman.de

Glasdüse Gr.7 [13NQ-7] WT-9/20/24/25 SW-320	859-QN070
Glasdüse Gr.9 [13NQ-9] WT-9/20/24/25 SW-320	859-QN090
Glasdüse Gr.5L [13NQ-5L] WT-9/20/24/25 SW-320	859-QN05L
Glasdüse Gr.7L [10NQ-7L] WT-17/18/26	859-QN07L
Glasdüse Gr.9L [10NQ-9L] WT-17/18/26	859-QN09L

Verschleißteile WT24

Pos.	Artikelbezeichnung	Artikel
	Set Ø1,6mm Gaslinse WT-24/24W	859-QN-24-16G
	Set Ø2,4mm Gaslinse WT-24/24W	859-QN-24-24G
	Set Ø1,6mm Gaslinse Düse L WT-24/24W	859-QN-24-16GL
	Set Ø2,4mm Gaslinse Düse L WT-24/24W	859-QN-24-24GL
40d	Isolator Gaslinse [53N66] WT-24/24W	85504660-W
41d	Spannhülse Ø1,6mm L=23mm [53N64] WT-24/24W	85113640-W
	Spannhülse Ø2,4mm L=23mm [24GLC332] WT-24/24W	85113323-W
52d	Gaslinse Ø1,6mm [45V43NQ] WT-9/20/24/25 SW-320	859-QN20-16G
	Gaslinse Ø2,4mm [45V44NQ] WT-9/20/24/25 SW-320	859-QN20-24G
43d	Glasdüse Gr.5 [13NQ-5] WT-9/20/24/25 SW-320	859-QN050
	Glasdüse Gr.7 [13NQ-7] WT-9/20/24/25 SW-320	859-QN070
	Glasdüse Gr.9 [13NQ-9] WT-9/20/24/25 SW-320	859-QN090
	Glasdüse Gr.5L [13NQ-5L] WT-9/20/24/25 SW-320	859-QN05L
	Glasdüse Gr.7L [10NQ-7L] WT-17/18/26	859-QN07L
	Glasdüse Gr.9L [10NQ-9L] WT-17/18/26	859-QN09L